

GENERAL CATALOGUE

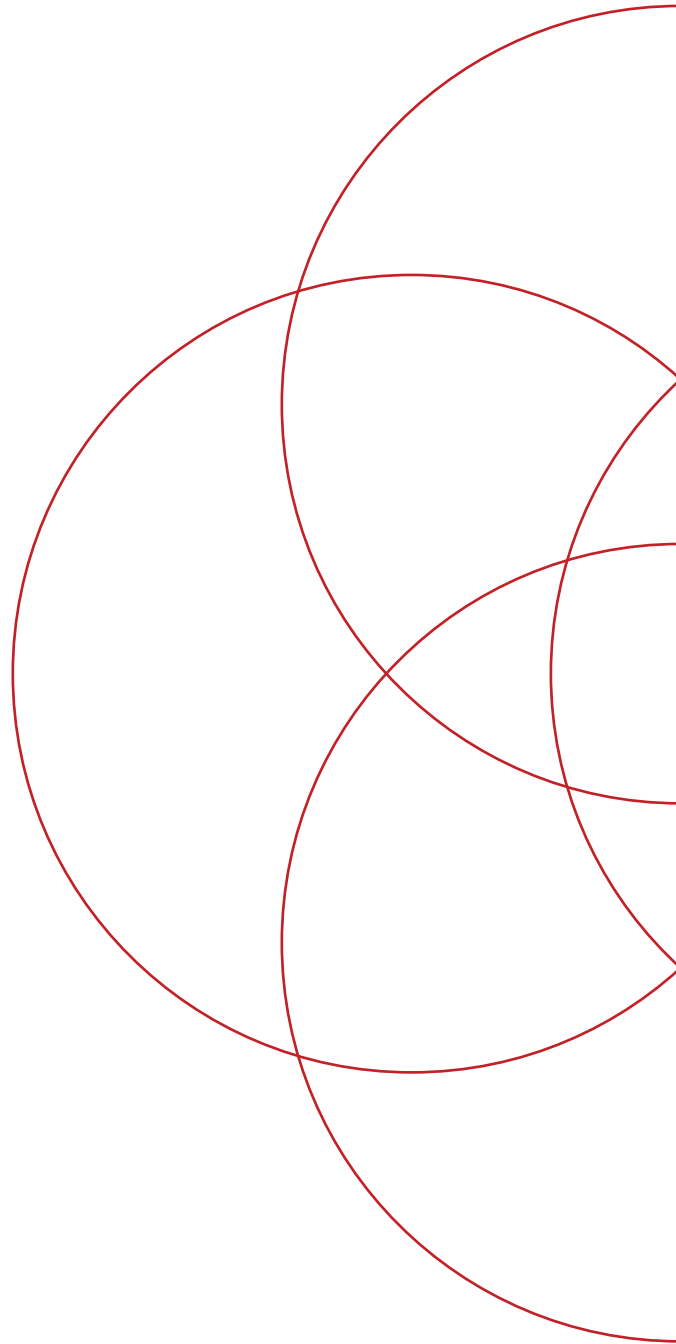



INDEX.

Lead

008

Diamond	010
Marble	018
Patro	040
Light	060
Trio	074

Operate

084

Cube	086
Cloud	130
Tetra	154
Universal Cabinets	184
Coffee Tables	200

Seating

206

Soft Seating	208
Executive Chairs	292
Task Chairs	348
Stools & Multipurpose Chairs	388
Auditorium Chairs	444
Seating Finishes	462

ABOUT RIADCO

We are a pioneering company that has made a difference in the industry since 1981. We have found innovative solutions for organizations' latent and future needs by studying work environments and embracing new ways of working to create long-lasting solutions that bring people, space, and information together. Riadco is known for its revolutionary concepts, blending architectural power, mechanical engineering delicacy, and insightful business sense to reimagine possibilities for domestic and international projects.

- FOUNDER_

ABDELFATTAH MOHAMED RIAD
- CHAIRMAN_

HANY ABDELFATTAH RIAD
- VICE CHAIRMAN_

HESHAM ABDELFATTAH RIAD
- VICE CHAIRMAN_

HAYTHAM ABDELFATTAH RIAD



LEFT: HISHAM RIAD | CENTER: HANY RIAD | RIGHT: HAYTHAM RIAD

OUR PRODUCTION

The limitless manufacturing capabilities begin with a workforce of 500 skilled professionals operating 3 organized and efficient plants, spanning over 50,000 sqm, dedicated to wood panel, metalwork, and upholstery; ensuring high production rates to meet the diverse needs of our clients. Riadco has a vast network of showrooms across Egypt while distributing globally, guaranteeing utmost dedication to delivering exceptional craftsmanship, innovative designs, and quality.





The Lead range offers a sophisticated and refined aesthetic, enhancing interior spaces with its timeless elegance and contemporary flair. Each piece, a masterpiece of design and craftsmanship, is meticulously crafted to endure the test of time. This exclusive collection offers a sophisticated and refined living experience.

LEAD

RANGE

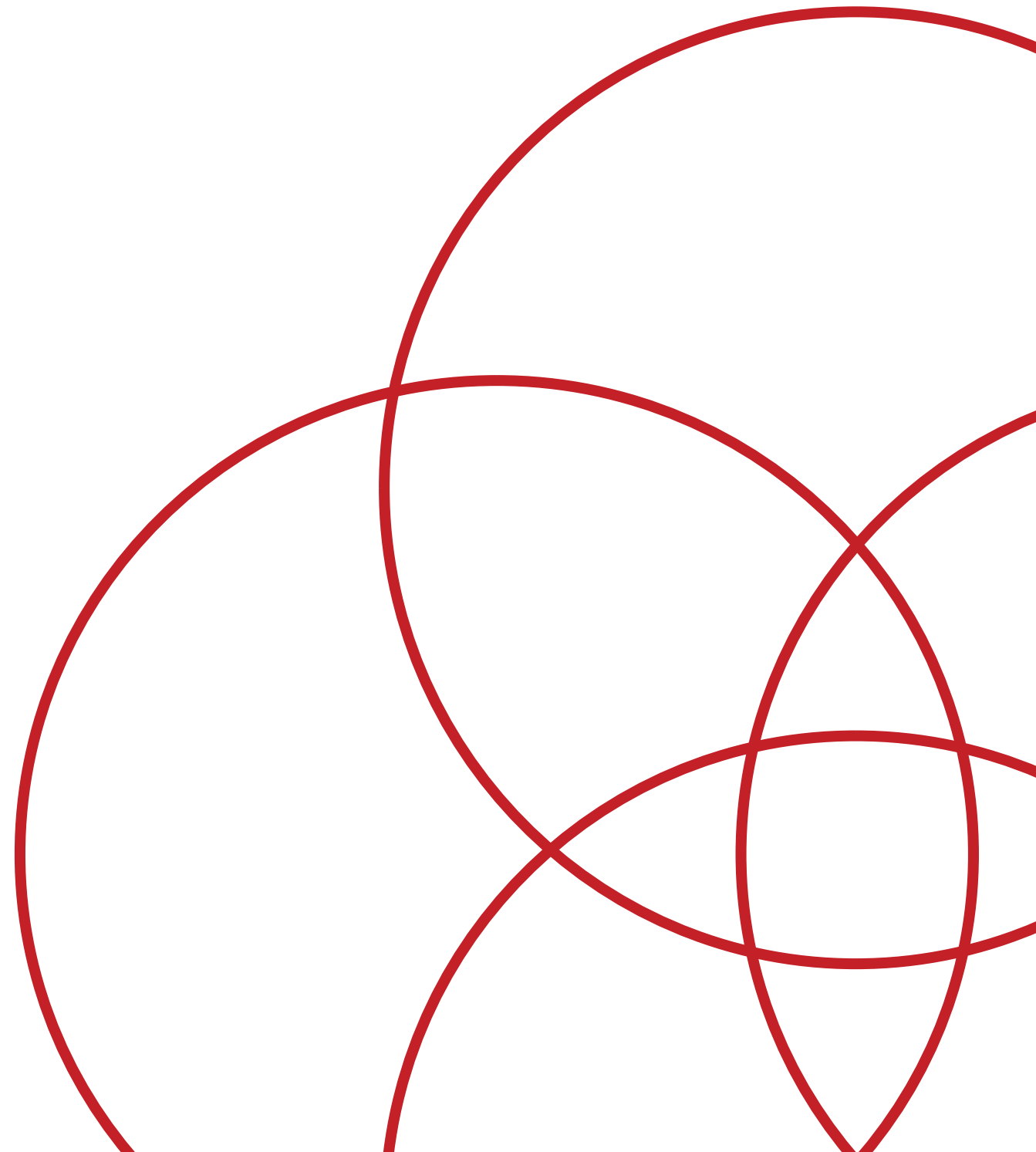



DIAMOND /LEAD

“

The Diamond collection is a stunning range of executive furniture that redefines the modern workspace. Each piece is meticulously crafted to blend seamlessly with contemporary interiors, offering a perfect balance of style and functionality. The striking contrast between the sleek black and elegant champagne finishes creates a visually stunning and sophisticated aesthetic. The meticulously crafted side unit, available in either finish, offers ample storage and display space.

”



The high-gloss finish adds a touch of glamour, while the geometric design elements lend a contemporary edge. The use of premium ebony veneer adds a touch of luxury and sophistication to each piece. Whether you prefer a bold and dramatic look or a more understated elegance, Diamond collection offers the perfect solution for any executive workspace.

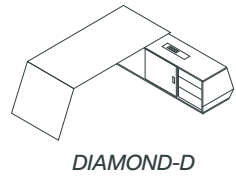

The desk in the Diamond collection is a masterpiece of modern design, with its clean lines and dramatic angles. The ebony wood veneer creates a visually stunning focal point, while the integrated side unit provides convenient storage and display space.

SPECIFICATIONS:

Diamond collection exudes sophistication and luxury, featuring a striking combination of materials and finishes.

Desk top and side unit cupboards :

Material : high-gloss ebony wood veneer with options in lacquer champagne or glossy black
Metal accents : gold stainless steel details

High cabinet :

Doors : premium glass.
Body : lacquer champagne or glossy black
Accents : gold stainless steel

Low cabinet :

Finish : high-gloss ebony wood veneer
Body : lacquer champagne or glossy black
Accents : gold stainless steel

Coffee table :

Legs : gold stainless steel
Top : high-gloss ebony wood veneer

Meeting table :

Legs : lacquer champagne or glossy black
Top : ebony wood veneer

DIAMOND ABACUS

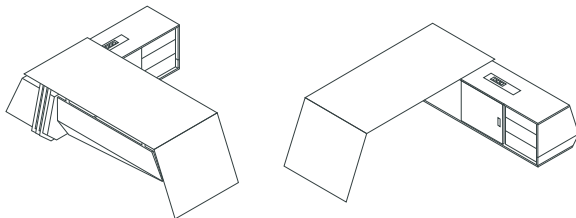

DIAMOND-D

L 270
D 211
H 82

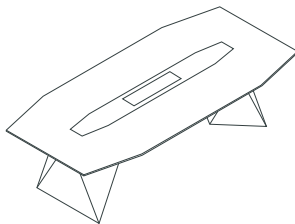

DIAMOND-MT

L 240 / 280 / 350 / 450
D 120/130/150
H 78

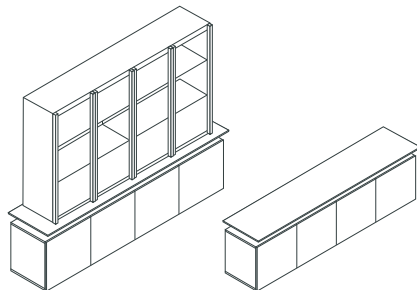

DIAMOND-HC/LC

L 230
D 50
H 81/200

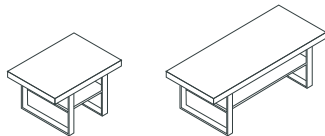

DIAMOND-WT-120/60

L 60 / 120
D 50
H 40

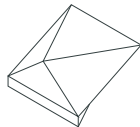

DIAMOND-CT-70

L 72
D 80
H 45

FINISHES

Wood Veneer /



RV05
EBONY

Lacquer Paints /



RLP02
BLACK



RLP04
CHAMPAGNE

Stainless Steel /



RSS03
GOLD PVD



MARBLE

/LEAD

“

Marble is an elegant executive collection that is crafted from high-quality materials in response to the need for a prestigious and tastefully luxurious office, featuring a thick top made of poplar plywood sandwiched between MDF boards, veneered with thick Ash-tinted oak . The surface is characterized by longitudinal grout lines, giving it a unique slat-like appearance that exudes refinement and sophistication. The desk's design features a standard configuration that includes a box drawer and file drawer. This design ensures ample space to work and organize belongings, while maintaining a sleek and streamlined appearance.

”



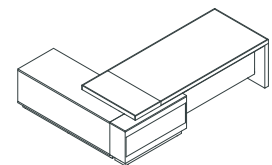

MARBIL - D - 260 - T - M - R

One of the standout features of the Marble desk is its distinctive design aesthetic. Marble desk is a sophisticated L-shaped desk that is constructed with a combination of plywood and MDF, veneered with thick Ash-tinted oak. The front panel of the desk showcases a black marble accent, adding a luxurious touch. The design is modern and minimalist, with clean lines and a functional aesthetic.



SPECIFICATIONS:

Marble Collection exudes sophistication and luxury, featuring a striking combination of materials and finishes.

Desk top and side unit cupboards :

Material : poplar plywood sandwiched between MDF boards and veneered with thick ash-tinted oak

Low cabinet :

Finish : Ash-tinted oak veneer
Body : poplar plywood and MDF
Handles : Metal
Base : Black PVC

Meeting table :

thick ash-tinted oak veneer
Marble Accents
PVC

Coffee table :

thick ash-tinted oak veneer
PVC
Aluminum frame

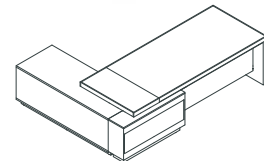

MARBIL - D - 260 - T - M - R



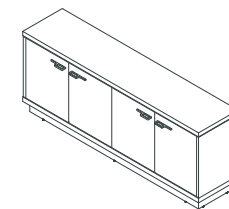

MARBIL- LC - 200 - T-M



The sleek and modern design of the Marble storage unit features four hinged doors that provide easy access to the interior space, while the top, sides, and legs are made from durable PVC finish. The doors themselves are crafted from high-quality veneer, adding a touch of sophistication to the overall design.

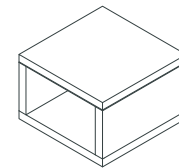

MARBIL - WT - 60 - T-M

Our multipurpose coffee tables are designed to provide a unique combination of style and functionality. The 60 x 60 model features a compact footprint that makes it perfect for small spaces.

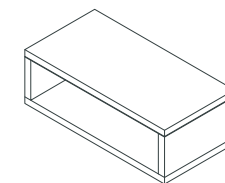

MARBIL - WT - 120 - T-M

While the 120 x 60 coffee table model provides a larger surface area for working. Both tables are constructed with high-quality materials.



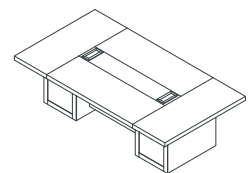

MARBIL- MT - 320 - T-M-R

The Marble meeting table features a clean, modern design with a smooth surface and sturdy legs. It is accented with dark marble panels, adding an elegant touch. The table includes an inset panel, for cables, enhancing its utility for meetings. It also has different sizes suitable for larger meetings or settings. The overall aesthetic combines luxury and functionality, making it a central piece in a professional environment.



MARBLE ABACUS

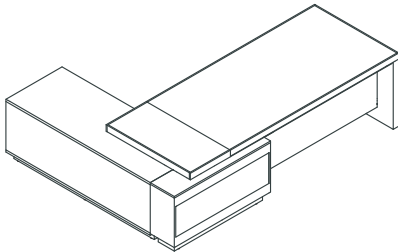

MARBIL-D - 260/280 - T-M-R

L 260 / 280
D 100
H 75

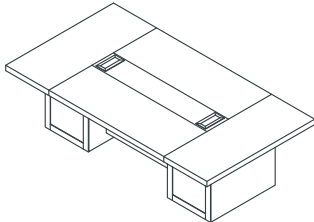

MARBIL-MT - 280/320/360/400/420/450 - T-M-R

L 280 / 320 / 360 / 400 / 420 / 450
D 150/170
H 75

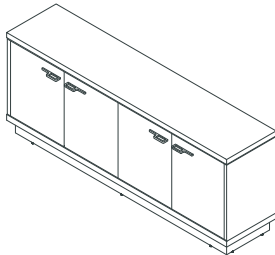

MARBIL-LC - 200 - T-M

L 200
D 45
H 80

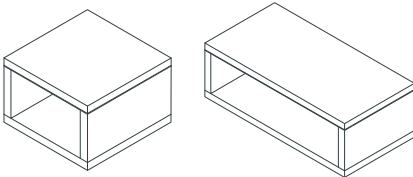

MARBIL-WT - 120/60 - T-M

L 120 / 60
D 60
H 46

FINISHES

Wood Veneer /



RV02
BEECH



RV03
WALNUT

PVC /



RPVC02
BLACK

Acrylic /
Marble



RMA04
1971L



PATRO /LEAD

“

Patro collection is an elegant fusion of neo-classical design and modern comfort. It is an executive office desk in solid wood and finished in walnut natural veneer. Thanks to a design with timeless charm, enriched with lines, shades and details, it can embellish all environments, making them always fashionable and noble. It embodies elegance, luxury and value enhancing and enriching any type of room.

”



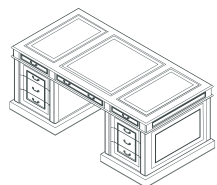

CLSP - D - 200 - G - M

This luxurious desk is designed to provide a sense of elegance and sophistication to any workspace. Below the top, there are nine drawers: three on the left, three on the right, and three in front of you.

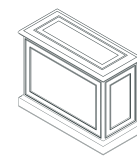

CLSP - SD - 50 - G - M

The collection features a range of seating modules in various shapes and sizes, all designed to be easily combined and rearranged to suit different needs and preferences. The possibilities are endless.

SPECIFICATIONS:

Top :

Material : solid wood and MDF
Thickness : 19-25 mm
Veneer : Beech wood
Finish : Natural walnut plate, 0.5 mm thick

Legs :

Material : solid wood and MDF, 19 mm thick.
Veneer : Natural walnut , 0.5 mm thick.

Drawers :

Body : solid wood and MDF with a density of 620 kg/m³, 16 mm thick.
Veneer : Natural walnut, 0.5 mm thick.
Frame : Beech wood, 13 mm thick.
Borders : MDF, 19 mm thick, and natural cherry plate, 0.5 mm thick.

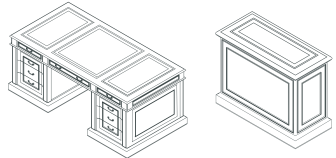

CLSP - D - 180/200/240 - G - M
CLSP - SD - 50 - G - M

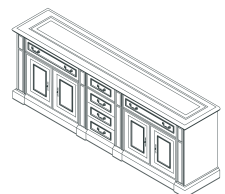

CLSP-LC-230-G-M

Patro cabinet features a rectangular top, providing ample display space. Below the top, there are four doors with decorative panels. On the center section, there are four drawers with gold handles. It's a perfect piece for adding a touch of luxury to any room.

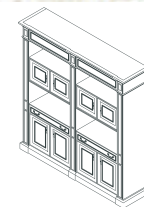

CLSP-HC-200-G-M

Patro collection embodies the perfect blend of form and function. The collection includes a variety of pieces, all designed to work seamlessly together to create a cohesive and harmonious look.

SPECIFICATIONS:

Cabinet Body :

Material : Solid wood and MDF with a density of 620 kg/m3.
Veneer : Natural walnut, 0.5 mm thick.

Doors :

Material : Solid wood and MDF, 19 mm thick.
Frame : Beech wood.
Covering : Natural walnut , 0.5 mm thick.

Shelves :

Material : Solid wood and MDF with a density of 620 kg/m3, 22 mm thick.
Veneer : Beech wood and natural walnut, 0.5 mm thick.

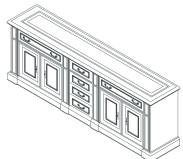

CLSP - LC - 230 - G - M

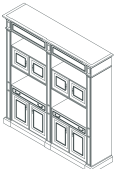

CLSP - HC - 200 - G - M

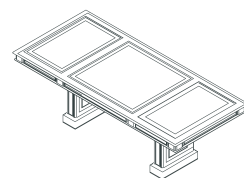

CLSP - LC - 230 - G - M

The meeting table synthesises the collection aesthetic lines. The entire composition plays with the differences in the thickness and materials of worktop and legs.



The Patro collection offers a comprehensive executive office solution. It creates a cohesive and inspiring workspace, characterized by intricate details, graceful lines, and warm, inviting tones that enhance any office setting. The Patro collection provides the perfect environment for productivity and creativity.

SPECIFICATIONS:

- Top :**
Material : Solid wood and MDF
Thickness : 115 mm
Veneer : Beech wood
Finish : Natural walnut plate, 0.5 mm thick
- Legs :**
Material : Solid wood and MDF, 180 mm thick.
Veneer : Natural walnut , 0.5 mm thick.

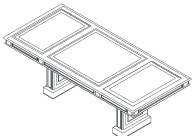

CLSP - LC - 230 - G - M

SPECIFICATIONS:

- Top :**
Material : Solid wood and MDF
Thickness : 50 mm
Veneer : Beech wood
Finish : Natural walnut plate, 0.5 mm thick
- Legs :**
Material : Solid wood and MDF, 65 mm thick.
Veneer : Natural walnut , 0.5 mm thick.

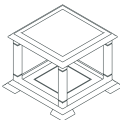

CLSP - WT - 60 - G - M

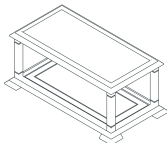

CLSP - WT - 120 - G - M

PATRO ABACUS

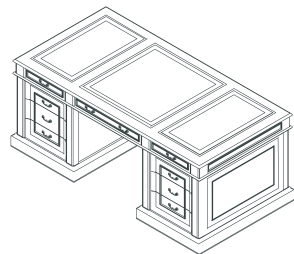

CLSP - D - 180/200/240 - G - M
L 180 / 200 / 240
D 100
H 75

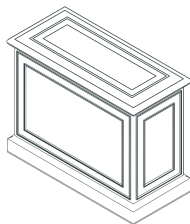

CLSP - SD - 50 - G - M
L 100
D 50
H 75

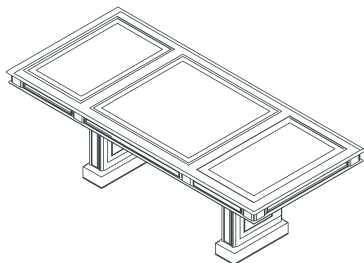

CLSP-MT-200/240/320/380/480 -G-M
L 200 / 240 / 320 / 380 / 480
D 120 / 140 / 160 / 180
H 75

FINISHES

Wood Veneer /



RV03
WALNUT



RV04
CHERRY

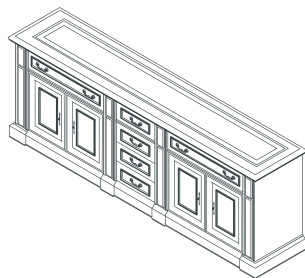

CLSP - LC - 230 - G - M
L 230
D 45
H 80

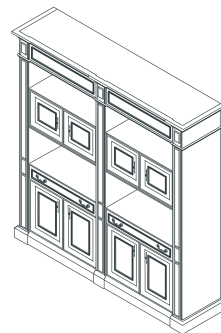

CLSP - HC - 200 - G - M
L 200
D 45
H 80

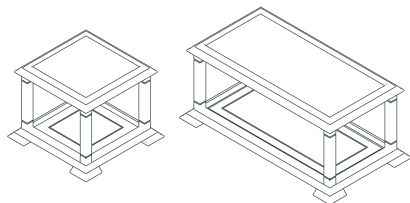

CLSP - WT - 60/120 - G - M
L 60 / 120
D 50
H 75



LIGHT / LEAD

“

Light is an executive collection where design and comfort come together for a pleasant and intriguing work environment that does not want to give up the elegance of shapes and colors. Light is a prestigious desk designed for contemporary and refined spaces. The work top of the desk, with an important thickness, is the focal element of the furniture, around which all the other elements develop harmoniously.

”



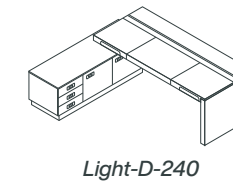

The Light desk features a spacious design with a length of 240 cm, depth of 210 cm, and height of 75 cm. The desk has multiple drawers for organized storage. The side unit includes drawers and cabinets for additional storage. It provides extra workspace and a cohesive look. Both pieces blend functionality with style.

SPECIFICATIONS:

**Light is an innovative approach to professional distinction.
The collection is flexible to meet all top-tier business needs.**

Manufactured using wood panels (HPL) for tops and legs
Off-white solid paint finish.

Desk Dimensions :

Length : 240 cm
Depth : 210 cm
Height : 75 cm

Top :

Thickness : 60 mm
Leg thickness : 8 cm

Hidden Electrification :

Includes aluminum cable pass with hidden electrification system.

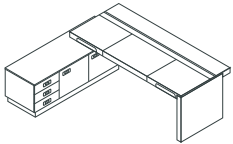

Light-D-240

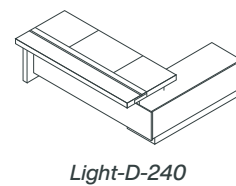

The contrasting wood and white finish creates a stylish and professional look. Two convenient drawers provide ample storage for your essentials, keeping your workspace organized and clutter-free.

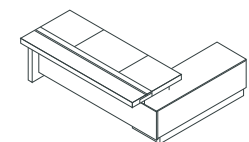

*Light-D-240*

LIGHT ABACUS

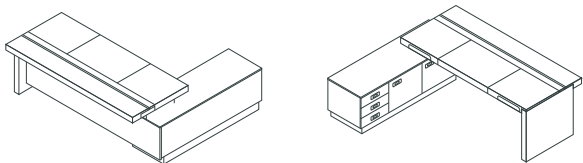

Light-D-240

L 240
D 210
H 75

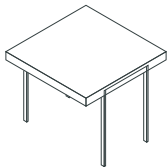

Light-WT-6060/1260

L 120 / 60
D 60
H 47

FINISHES

HPL /



RHPL05
K015

Lacquer Paints /



RSP03
Off White



TRIO / LEAD

“

The Trio is a sophisticated blend of form and function. Its L-shaped design maximizes workspace, providing ample room for all your office essentials. The combination of sleek white and rich wood tones creates a modern and inviting aesthetic that complements any contemporary office setting.

”



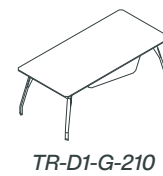

Crafted with attention to detail, the Trio features integrated storage solutions and a durable construction, ensuring both functionality and longevity.

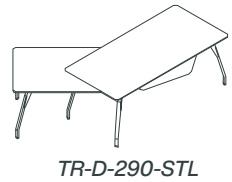

The Trio Desk provides the perfect foundation for a productive and inspiring workspace. It's ergonomic design and thoughtful features contribute to a comfortable and efficient work experience

SPECIFICATIONS:

Desktop :

25mm chamfered MDF top with membrane finishing or in 12mm glass top.

Legs :

Formed stainless steel tube legs with adjustable feet.

Storage Unit :

Modular storage units with doors and open shelves.

Available in 3 heights.

2 plain colors for the storage structure.

Variety of wood finishes and plain colors for the doors.

Drawers :

Drawers on castors with self-closing system.

Meeting Tables :

Circular and rectangular meeting tables available.

TRIO ABACUS

Top Options / 25mm MDF or 12mm Glass

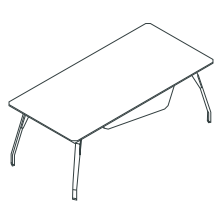

TR-D1-G-210

L 210
D 100
H 75`

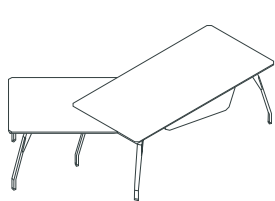

TR-D-290-STL

L 290
D 100
H 75

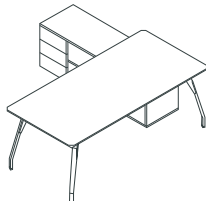

TR-DSR-2316

L 210
D 100
H 75

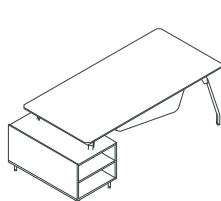

TR-D4-1980

L 210
D 100
H 75

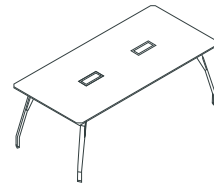

TR-TMT-210

L 210
D 100
H 75

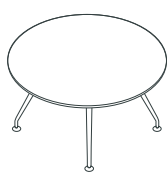

TR-MTR-3L/4L-120/100

L 120 / 100
H 72



TR-DR-4060

L 60
D 40
H 48

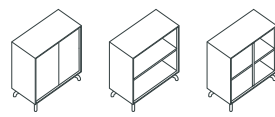

TR-LC / LC1 / LC2-8040

L 80
D 40
H 80

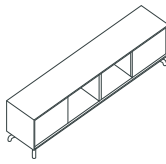

TR-LC4-180

L 180
D 40
H 50

FINISHES

PVC /

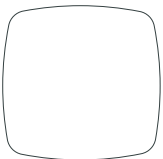

RPVC01
SNOW WHITE



RPVC02
BLACK



RPVC03
151-CHERRY



RPVC04
195-OAK



RPVC05
196-OAK



RPVC06
166-OAK



RPVC07
198-WALNUT



RPVC08
199-WALNUT

Lacquer Paints /



RLP01
WHITE



RLP02
BLACK

Stainless Steel /



RSS02
POLISHED

Glass /



RG01
BLACK



RG02
WHITE



RG03
FORSTED



RG04
BEIGE



The Operate range offers a comprehensive solution for both managerial and operational spaces. This collection balances form and function, providing innovative designs that are both aesthetically pleasing and highly adaptable to modern work environments. The focus on simplified yet detailed design ensures that the range can be easily customized to suit diverse needs, promoting flexibility and efficiency.

OPERATE

RANGE

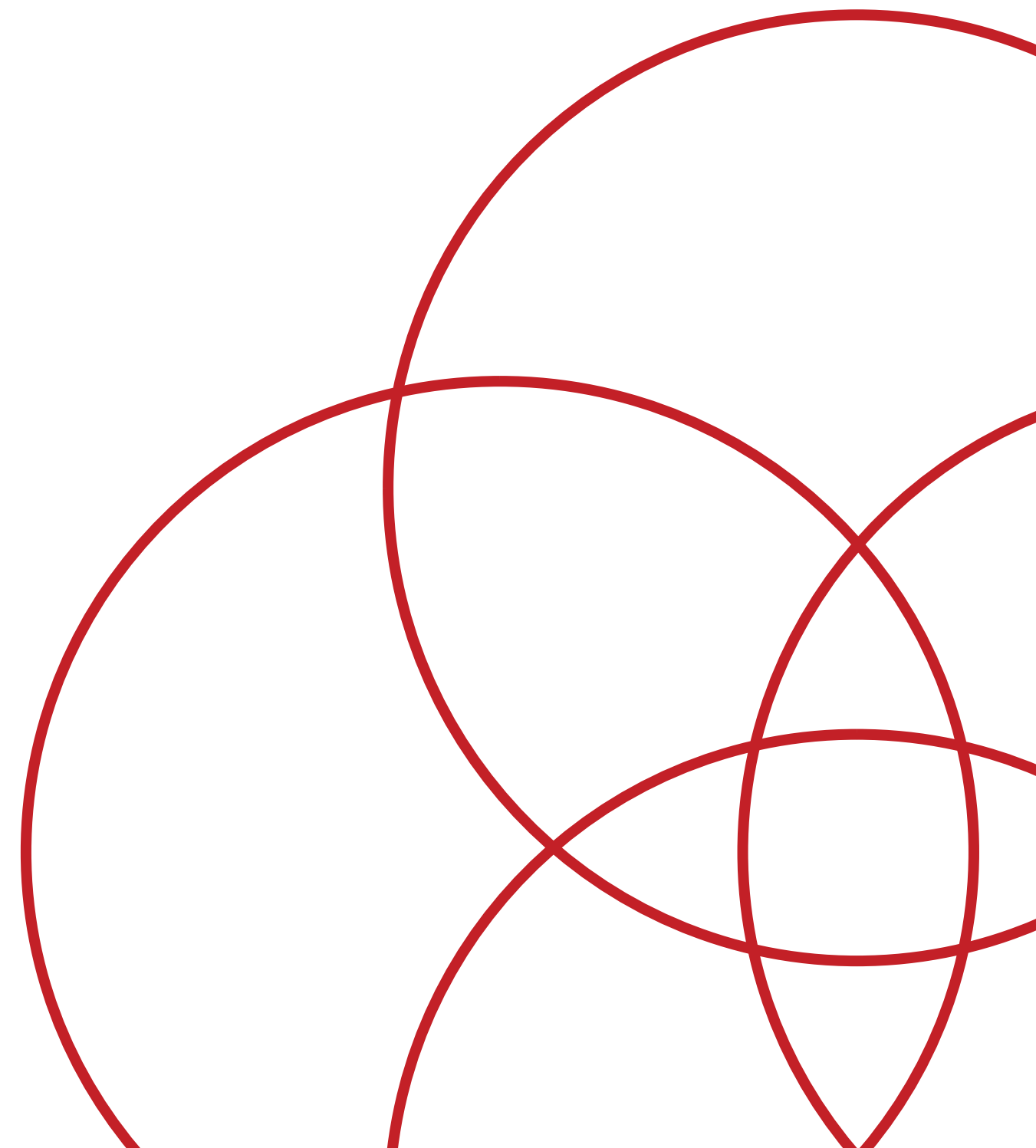



CUBE / OPERATE

“

Designed for contemporary work environments, Cube is perfect for individual offices or team meetings. It is ideal for activity-based workplaces where there is collaboration. With a special system for bench solutions, additional work areas can be easily arranged. The collection offers elegant designs and various laminate table top finishes. It combines functionality with a cohesive aesthetic.

”



SPECIFICATIONS:

- Desktop :**
18mm melamine-faced board with PVC edge banding.
- Base :**
Metal structure on 50x50mm metal tube box legs, 1.5mm thickness, featuring 15mm plastic adjustment feet.
- Metal Finish :**
Electrostatic powder coating paint.
- Side Attached Features :**
3 lockable drawers.
1 cabinet with a lockable door.
1 open storage space.
1 open CPU slot.
- Customization :**
Available with or without front modesty panel.
Various separator options.
- Hidden Electrification :**
Includes aluminum cable pass with hidden electrification system (excluding power source).

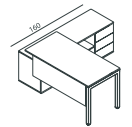

CUB - DS - LD

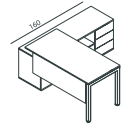

CUB - DS - LD



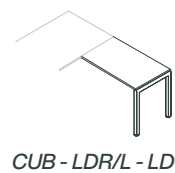

Managerial desks that have been carefully crafted to reflect a modern sensibility. Our desks are designed with a focus on both form and function, providing a harmonious balance that complements any office environment seamlessly.

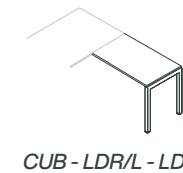

Each desk is thoughtfully designed to meet the demands of today's fast-paced business environment, offering a stylish yet functional solution for any workspace. With an emphasis on operational efficiency and ergonomic design, Cube desks are tailored to enhance work experience while adding a touch of elegance to any office setting.



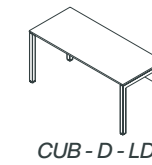

Operative desks are configured as a monolithic structure, with accurate construction details and tops that appears to float gently and elegantly over the sturdy frame which can be integrated harmoniously into any setting.

SPECIFICATIONS:

Desktop :

18mm melamine-faced board with PVC edge banding.

Base :

Metal structure on 50x50mm metal tube box legs, 1.5mm thickness, featuring 15mm plastic adjustment feet.

Metal Finish :

Electrostatic powder coating paint.

Customization :

Available with or without front modesty panel.

Various separator options.

Hidden Electrification :

Includes aluminum cable pass with hidden electrification system (excluding power source).

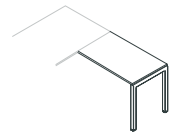

CUB - LDR/L - LD

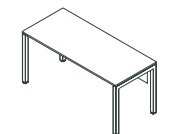

CUB - D - LD



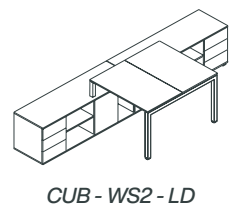

A variety of separators to choose from, whether it is acoustic panels or melamine faced boards with additional organizer accessories.



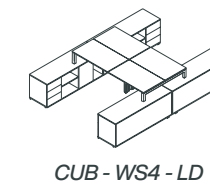

CUB - WS4 - LD

These workstations are designed with a shared layout making them perfect for accommodating accessories and creating an efficient and productive work environment.

SPECIFICATIONS:

Desktop :

18mm melamine-faced board with PVC edge banding.

Base :

Metal structure on 50x50mm metal tube box legs, 1.5mm thickness, featuring 15mm plastic adjustment feet.

Metal Finish :

Electrostatic powder coating paint.

Side Attached Features :

3 lockable drawers.

1 cabinet with a lockable door.

2 open storage space.

1 open CPU slot.

Customization :

Various separator options.

Hidden Electrification :

Includes aluminum cable pass with hidden electrification system (excluding power source).

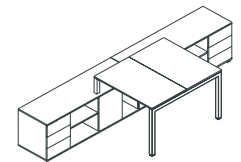

CUB - WS2 - LD

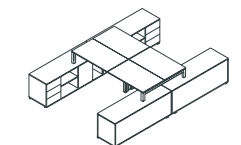

CUB - WS4 - LD

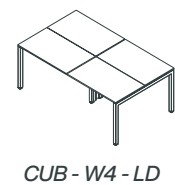

Large open spaces with workstations clearly defined. Dividing screens with optional hanging accessories system and acoustic solutions makes it the best fit for populated spaces. In addition to the service storage units that support double-bench, offering ample space for filing and wiring purposes.



SPECIFICATIONS:

Desktop :

18mm melamine-faced board with PVC edge banding.

Base :

Metal structure on 50x50mm metal tube box legs, 1.5mm thickness, featuring 15mm plastic adjustment feet.

Metal Finish:

Electrostatic powder coating paint.

Customization :

Various separator options.

Hidden Electrification :

Includes aluminum cable pass with hidden electrification system (excluding power source).

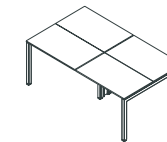

CUB - W4 - LD

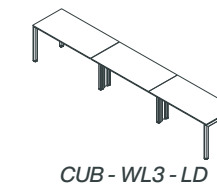

The lateral work bench creates dynamic and operational areas that are perfect for the modern office, where changes are essential. This combining form and function provides the ultimate blend of versatility and elegance. They are available in 2,4,6 and 8 seats.

SPECIFICATIONS:

- Desktop :**
18mm melamine-faced board with PVC edge banding.
- Base :**
Metal structure on 50x50mm metal tube box legs, 1.5mm thickness, featuring 15mm plastic adjustment feet.
- Metal Finish :**
Electrostatic powder coating paint.
- Customization :**
Various separator options.
- Hidden Electrification :**
Includes aluminum cable pass with hidden electrification system (excluding power source).

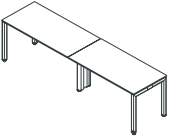

CUB - WL2 - LD



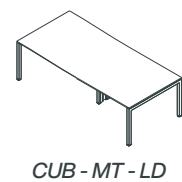

The Cube meeting tables are a versatile and adaptable solution that can be used in various settings, from open-plan offices to conference rooms.

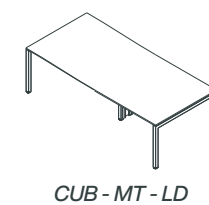

The sleek design and high-quality production make it a valuable addition to any workspace, promoting effective meetings and driving innovation.

SPECIFICATIONS:

Desktop :

18mm melamine-faced board with PVC edge banding.

Base :

Metal structure on 50x50mm metal tube box legs, 1.5mm thickness, featuring 15mm plastic adjustment feet.

Metal Finish :

Electrostatic powder coating paint.

Hidden Electrification :

Includes aluminum cable pass with hidden electrification system (excluding power source).

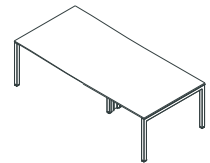

CUB - MT - LD

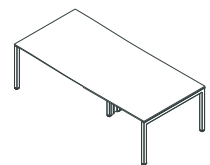

CUB - MT - LD



Coffee Tables

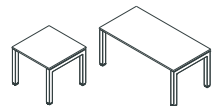

CUB-CT - LD

The Cube System offers a range of coffee tables that provide a comfortable and inviting space for socializing and relaxation. They're perfect for creating a warm and welcoming atmosphere in any office break room, reception area, or lounge.

Cube includes desk, bench, and a meeting table system that features geometric shapes and clean lines. Tops are available in (18 or 24 mm) and wide selection of leg finishes.

The system is perfectly integrated with special containers. Solutions are designed to obtain large surfaces and comfortable spacious storage spaces. Functional workstations that divide and characterize the space, creating autonomous workstations inspired by greatly operative criteria.

The range was developed to fit corporate, educational, and home office levels of collaboration and concentration environments. When it comes to furnishing any modern environment, Cube is the smart choice.

In any workspace, Cube delivers all of its adaptability. Individually or collectively, in a meeting room, a multi-purpose room, or even a home office.

CUBE ABACUS

Managerial Desks

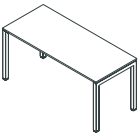

CUB - D - LD
L 160 / 180 / 200
D 80 / 100
H 75

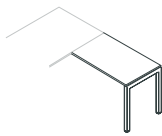

CUB - LDR/L - LD
L 100
D 60
H 75

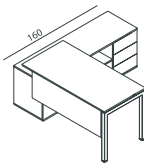

CUB - DS - LD
L 160 / 180 / 200
D 80
H 75

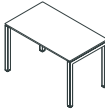

CUB - D - LD
L 100 / 120 / 140 / 160
D 60 / 70
H 75

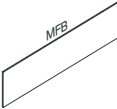

CUB - MP - L
L 100/120/140/160/180/200
D 18
H 40

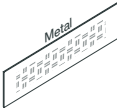

Meeting Tables

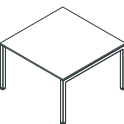

CUB - MT - LD
L 120 / 160 / 200 / 240 / 280 / 360
D 120
H 75

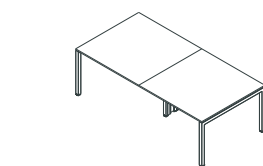
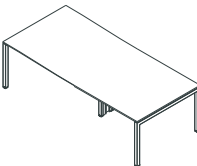

160 / 180 / 200
100

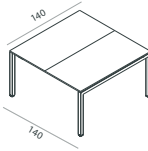

CUB - MT - 140140
L 140
D 140
H 75

Coffee Tables



CUB - CT - LD
L 60 / 120
D 60
H 50

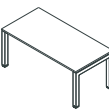

Workstations

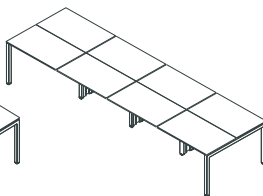
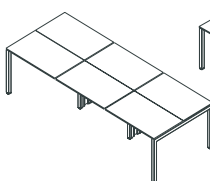
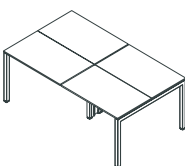
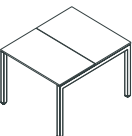

CUB - W8/6/4/2 - LD
L 80 / 100 / 120 / 140 / 160
D 60 / 70
H 75

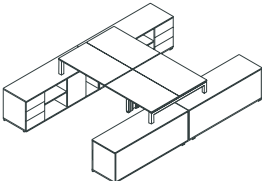
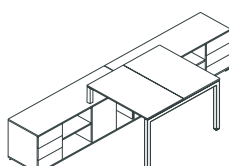

CUB - WS4/2 - LD
L 140 / 160 / 180
D 60 / 70
H 75

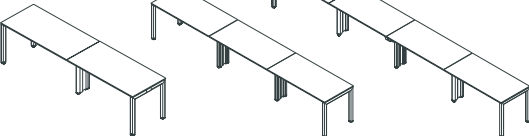

CUB - WL 4/3/2 - LD
L 80 / 100 / 120 / 140 / 160
D 60 / 70
H 75

Service Units

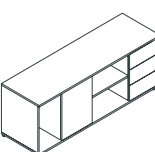

CUB - SU16050 - 1
L 160
D 50
H 57

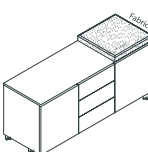

CUB - SU12040 - 2
L 120
D 40
H 56

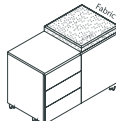

CUB - SU7540 - 3
L 80
D 40
H 56



CUB - SU5040 - 4
L 40
D 40
H 56



CUB - SU16050 - 1
L 160
D 60
H 57

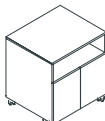

Seperators /Panels

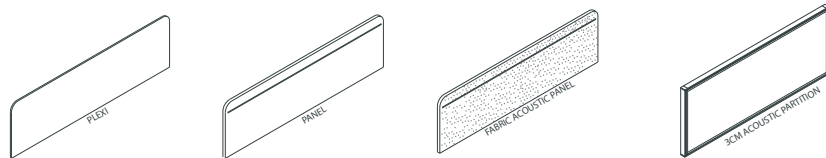

CUB - PLEX/PAN/FAB/ACO - L
L 60 / 80 / 100 / 120 / 140 / 160 / 180
W 1.8
H 35

Accessories



L 8 / 16
D 50
H 2.5

FINISHES

Melamine /
(MFB)



METAL /
ELECTROSTATIC
POWDER COATING



METAL /
STAINLESS
STEEL





CLOUD / OPERATE

“

Height-adjustable desks provide both ergonomic support and functionality, enabling users to change their posture throughout the day and work while sitting or standing. The compact and versatile single version allows for customizable layouts to accommodate various requirements. It's specifically designed and tested to enhance workplace productivity.

”



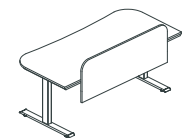

CLO-D-140/160

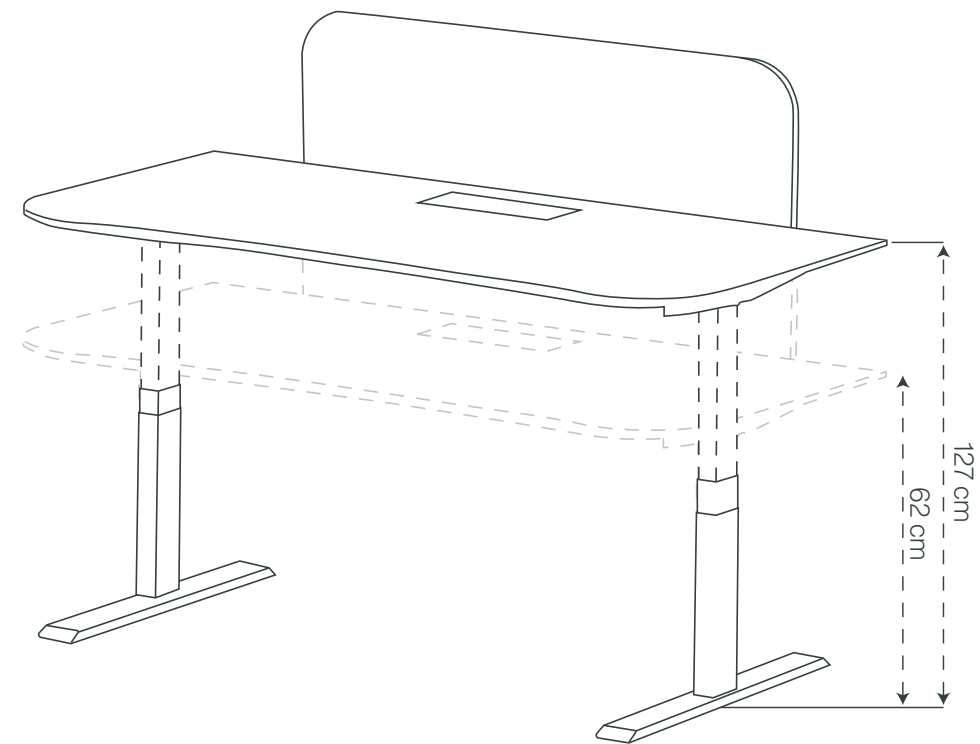

The Cloud desk features a sleek and modern design. It incorporates an electronic controller feature that enhances its versatility and user experience and allows users to easily adjust the desk height, enabling seamless transitions between sitting and standing positions for optimal comfort and ergonomic support.

SPECIFICATIONS:

Cloud Desk with Adjustable Height (H.62/127) - Motorized System, features:

- Desktop :**
MDF material.
PVC finish with thickness of 25mm.
Chamfered edge design.
- Legs :**
Two motorized "T" legs with telescopic metal tubes.
Rectangular section of 90x60x2mm.
- Finish :**
White electrostatic powder coating paint finish.
- Other Features :**
Central telescopic supporting beam for different desk lengths.
Electrical control unit.
Up/down push-button panel with memory setting.
White aluminum cable flap with a length of 270mm.
Optional 18mm modesty panel available in HPL finish.

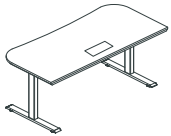

CLO - D - 140 / 160

The Cloud desk includes optional modesty panels and separators that not only enhance its aesthetic appeal but also improve functionality.

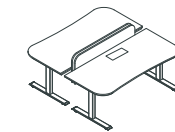

CLO - D - 140 / 160

The Cloud double workstation promotes collaboration with its simple yet elegant design. It offers a soft edge desktop, T-leg base with floor compensation, and a flexible two-part column with customizable height settings. Users can connect or divide single workstations as needed, facilitating teamwork and communication.

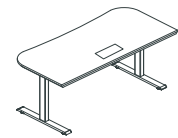

CLO - D - 140 / 160

The Cloud lateral workstation is a versatile and efficient solution for modern workspaces that prioritize collaboration and flexibility. With its sleek and contemporary design, this workstation offers ample workspace for multiple users to work side by side comfortably. The lateral layout of the workstation encourages communication and teamwork among colleagues while providing individual space for focused tasks.

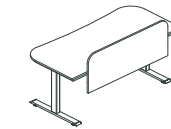

CLO - D - 140 / 160

It is crafted from high-quality materials that ensure durability and longevity. Its ergonomic design promotes good posture and comfort, supporting users during long hours of work. Whether used in open office spaces, or collaborative areas, the Cloud lateral workstation combines functionality with a contemporary aesthetic to enhance the overall workspace experience.



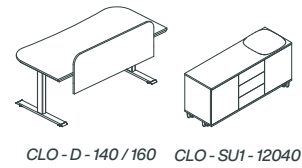

The Cloud workstation is a versatile and modular solution that offers a unique way to customize any workspace. With its triple telescopic rectangular column design, the Cloud can be easily adjusted to different heights and configurations, making it perfect for collaborative work or individual tasks. Additionally, the Cloud has a built-in cable management system, keeping your workspace organized and clutter-free.





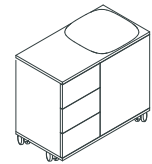

CLO - SU2 - 7540

The Cloud versatile service unit is a multi-functional piece designed to enhance office productivity. It boasts a spacious work surface, multiple drawers for efficient storage, and a built-in cushioned seat that can be used for additional seating or as a footrest.

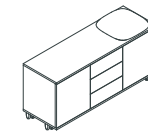

CLO - SU1 - 12040



CLO - SU3 - 5040

Finished with a stylish combination of a darker top and a lighter base, this unit adds a touch of sophistication to any workspace. Equipped with casters, it moves effortlessly around the office, providing flexibility and convenience for various tasks.





Cloud consists of a desktop, a base, two columns, and two T-legs, designed to provide sturdy and adjustable workstations. The desktop features a soft edge design, while the T-leg base has 10mm of floor compensation to ensure stability.

The two-part column can be adjusted to a height range of 62-127cm, allowing users to customize their working position.

The sit-stand system promotes a healthier work routine by allowing users to change their working position throughout the day, reducing the negative impacts of prolonged sitting.

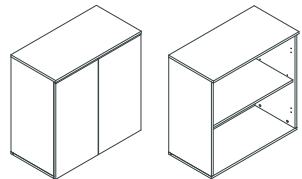

UC-LC1-8080

UC-LCO-8080

Smart storage units complement the Cloud workstations, providing versatile storage solutions for various workplace needs. The high modularity of these units enables complex layouts and configurations, catering to executive or operational environments seamlessly.

CLOUD ABACUS

Adjustable Desks

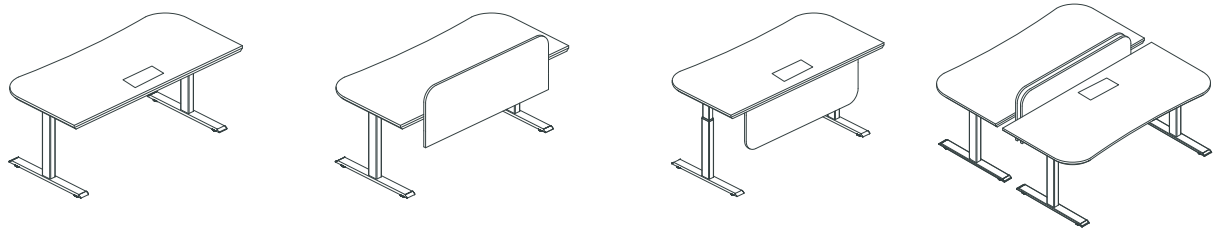

CLO - D - 140 / 160
L 140 / 160
D 75
H 62 - 127

Service Units

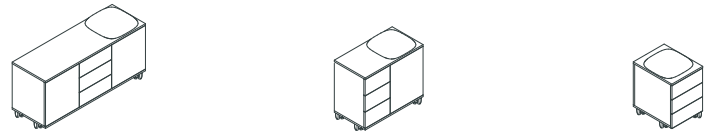

CLO - SU1 - 12040
L 120
D 40
H 56

CLO - SU2 - 7540
L 75
D 40
H 56

CLO - SU3 - 5040
L 50
D 40
H 56

FINISHES

PVC /
DESKTOP

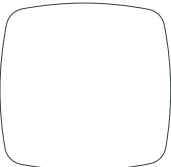

RPVC01
SNOW WHITE

MELAMINE “MFB” /
SERVICE UNIT BODY

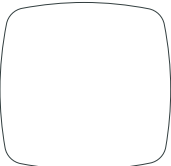

R14
BU66-PEARL

HPL /
SEPERATORS AND
SERVICE UNIT TOPS



RHPL01
CERAMIC RED



RHPL02
MIDNIGHT BLUE



RHPL03
OCEAN GREEN



RHPL04
MINT



TETRA / OPERATE

“

Tetra is a contemporary furniture collection designed to accommodate diverse and evolving ways of working. By combining a sleek design, advanced technical features, and a vibrant color palette, the collection enables individuals to personalize their work environment and express their unique character. With a focus on quality materials and aesthetically pleasing design, Tetra is a strong statement piece that embodies a commitment to excellence.

”



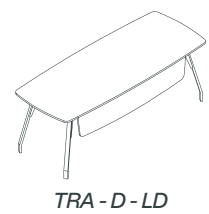

The Tetra office system is designed to create a productive and communicative workspace, suitable for various office layouts and settings. It's a modular solution that combines unique private offices, team workspaces, meeting areas, and project areas.



SPECIFICATIONS:

Desktop :
18mm thick laminated wood tabletop with recessed flip lids for cable access.

Base :
Steel legs with angled design for stability.
Powder-coated finish (available in 3 different colors).

Storage Unit :
Features a door, three drawers, and an open shelf.
White Melamine finish with a variety of plain colors for the top.

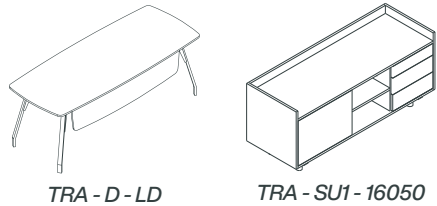

The design is sleek and space-efficient, maximizing the use of available space. It's a practical choice for modern work environments



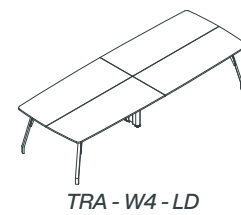

The Tetra workstation emphasizes functionality, ergonomics, and aesthetics, making it suitable for contemporary office settings.

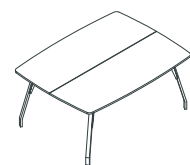

TRA - W2 - LD

Each workstation can be configured to accommodate different layouts, it is equipped with a sturdy central support structure. They're available in different colors, allowing for customization to fit various office themes.



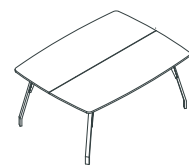

TRA - W2 - LD

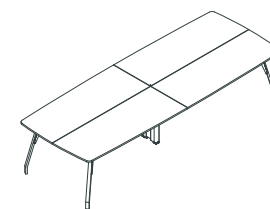

TRA - W4 - LD



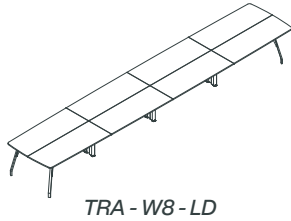

The Tetra workspace utilizes a benching system for its workstations. It allows employees to focus on their tasks while still maintaining a sense of connection within the open-plan environment. Each workstation includes features such as cable management and power outlets for convenient access to technology.



SPECIFICATIONS:

Desktop :
Laminated wood tabletop with recessed flip lids for cable access.

Base :
Steel legs with angled design for stability.
Powder-coated finish (available in 3 different colors).
Center column for cable management.

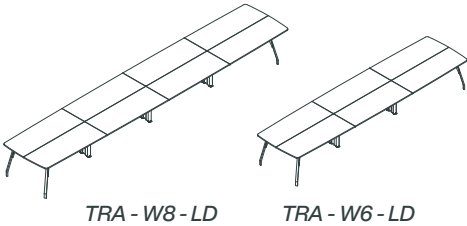



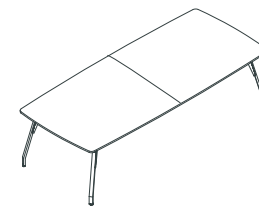

TRA - MT - LD

The Tetra meeting table is designed to accommodate collaborative settings. It has a central support design that provides stability. It offers several length options to fit various room sizes and meeting requirements.

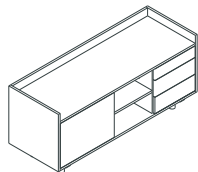

TRA - SU1 - 16050

Tetra service units are modern and practical, providing a mix of open and closed storage for organizational needs. It has a cupboard with a door, an open shelf with two compartments and three drawers. The top is available in various colors.

TETRA ABACUS

Managerial Desks



TRA - D - LD
L 180 / 200
D 90
H 75



TRA - LDR/L - LD
L 100
D 60
H 75

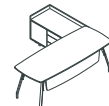

TRA - DS - LD
L 160 / 180 / 200
D 80 / 90
H 75

Operative Desks



TRA - D - LD
L 120 / 140 / 160
D 80
H 75

Modesty Panel

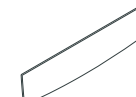

TRA - MP - L
L 120 / 140 / 160 / 180
D 18
H 35

Workstations



TRA - W 2 / 4 / 6 / 8 - LD
L 120 / 140 / 160
D 60
H 75

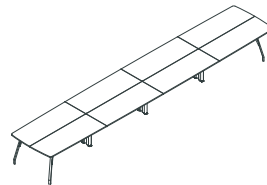
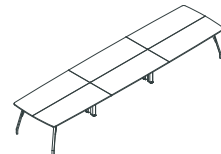
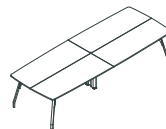

Meeting Tables



TRA - MT - LD
L 120 / 160 / 200 / 240 / 300 / 360
D 120
H 75

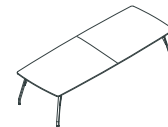

Service Units

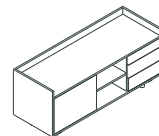

TRA - SU1 - 16050
L 160
D 50
H 57

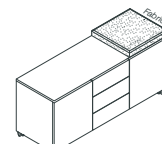

TRA - SU2 - 12040
L 120
D 40
H 56

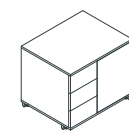

TRA - SU3 - 7540
L 75
D 40
H 56



TRA - SU4 - 5040
L 50
D 40
H 56



TRA - SU5 - 6556.8
L 65
D 56.8
H 62

Seperators panels



TRA - PAN - LD
L 120 / 140 / 160
D 17
H 35

Accessories



L 16
D 8
H 2.5

FINISHES

Melamine /
(MFB)



R01
White Ash



R02
Chestnut



R03
Istanbul Walnut



R04
White Chestnut



R05
910-Milk



R06
215-Stone Grey



R07
908-Graphite Grey



R08
923-Black



R09
974-Oak



R10
945-Grey Oak



R11
993-Beige Fabric



R12
K015-Vintage Marine



R13
419-Cherry



R14
BU66-Pearl



R15
290-American Walnut



R16
329-Afro Walnut



R17
929-Black Ash



R18
907-Brushed Grey



R19
63-LightHouse

HPL/



RHPL01
Ceramic Red



RHPL02
Midnight Blue



RHPL03
Ocean Green

METAL /
ELECTROSTATIC
POWDER COATING



RMP01
White



RMP04
Ceramic Red



RMP05
Midnight Blue



RMP06
Ocean Green



RMP07
Stone Grey

METAL /
STAINLESS
STEEL



RSS01
Brushed



RSS02
Polished



UNIVERSAL CABINETS

/ OPERATE

“

The Universal Cabinets collection is crafted to address a wide range of storage requirements, allowing for seamless integration into any setting due to its diverse array of finishes. The sleek design of the cabinet doors can be enhanced with optional 18mm finishing panels for the top, bottom, and side components adding a sophisticated touch and creating a distinctive ambiance.

”



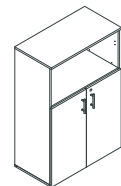

UC-MC20-80120

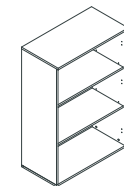

UC-MCO-80120

Featuring clean lines and a sleek design, the doors of the Universal Cabinets can be enhanced with optional finishing panels that protrude 18mm, adding an elegant frame that brings character and sophistication to any space.

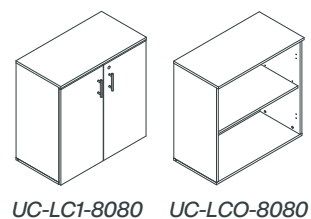

The Universal Cabinets come equipped with hinged doors, offering a versatile modular storage system. They feature a soft-close mechanism and 110° opening angle, which is adjustable on all three axes. Also, these hinges are certified for an up to 80,000 opening and closing cycles, ensuring longevity and resistance to tear.



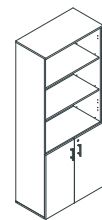
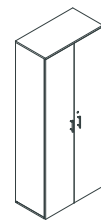

UC-HC21-8020 UC-HC20-8020

Beyond hinged doors, the collection also includes filing drawers designed with over-extension and heavy-duty rails, which support a weight capacity of up to 50 kg, and feature soft-close mechanisms or internal frames suited for organizing suspended files.





UC-HC21-8020

With four height options and two width choices (400 mm and 800 mm), and a selection from five distinctive handles, each cabinet could be tailored to match various aesthetic preferences and functional requirements.





UC-HC1-4020 UC-HCO-4020



Additionally, all doors, including the glass options, feature a standard lock with rotating rods to ensure safe and secure closure. For added security, an optional encrypted locking mechanism is available.

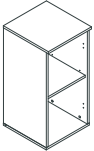

UNIVERSAL CABINETS ABACUS

L:40 D:42 H:80





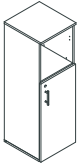
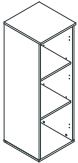

UC- LC1 LCO -4080

L:40 D:42 H:120





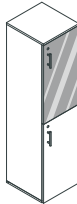

UC- MC1 MC1G MCO MC1O -40120

L:40 D:42 H:160

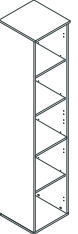
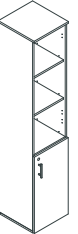

UC- HC1 HC2 HC1G1 HC1O HC4 HCO -40160

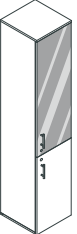
L:40 D:42 H:200



UC- HC1 HC2 HC1G1 HC1O HC4 HCO -4020

L:80 D:42 H:80

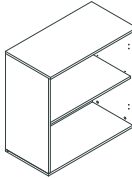
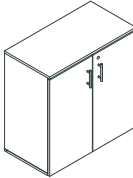

UC- LC1 LCO -8080

L:80 D:42 H:120

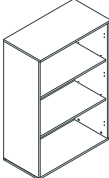
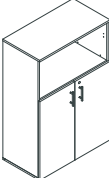
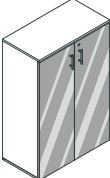
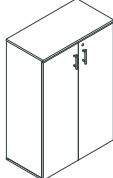

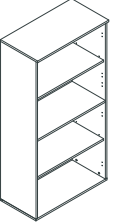
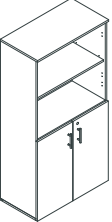
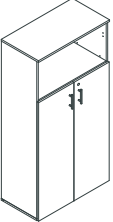
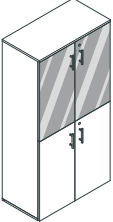
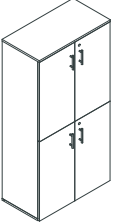
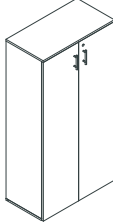

UC- MC2 MC2G MC2O MCO -80120

L:80 D:42 H:160

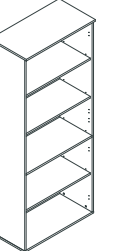
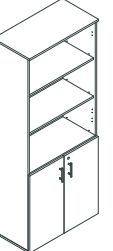
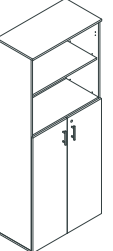
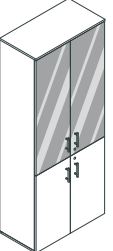
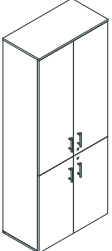

UC- HC2 HC4 HC2G2 HC3 HC2O HCO -80160

L:80 D:42 H:200



UC- HC21 HC4 HC2G2 HC3 HC2O HCO -8020

FINISHES

Melamine /
(MFB)



R01
White Ash



R02
Chestnut



R03
Istanbul Walnut



R04
White Chestnut



R05
910-Milk



R06
215-Stone Grey



R07
908-Graphite Grey



R08
923-Black



R09
974-Oak



R10
945-Grey Oak



R11
993-Beige Fabric



R12
K015-Vintage Marine



R13
419-Cherry



R14
BU66-Pearl



R15
290-American Walnut



R16
329-Afro Walnut



R17
929-Black Ash



R18
907-Brushed Grey



R19
63-LightHouse

HPL/



RHPL01
Ceramic Red



RHPL02
Midnight Blue



RHPL03
Ocean Green



COFFEE TABLES

/ OPERATE

“

The coffee tables are essential furnishing accessories for any space. They can be used to create a variety of looks, from sleek and modern to cozy and traditional giving a final touch that distinguishes the environment. By choosing the right materials, colors, and finishes, coffee tables can perfectly complement any existing decor in coordination with chairs and furnishing accessories to fill the space or they can contrast with them to stand out and attract attention.

”



LC ROUND

“

The LC round table is a sophisticated and contemporary coffee table that effortlessly blends elegance and functionality. Its circular glass top, paired with a sleek metal base featuring a unique polygon triangle design, creates a visually striking and modern aesthetic. This table is the perfect addition to any living space, adding a touch of artistic flair and contemporary style.

”

DIMENSIONS :

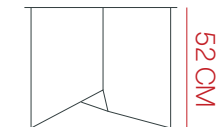
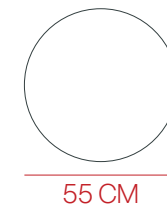

Leg base of 32.5 x 51 cm

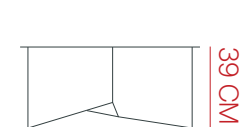
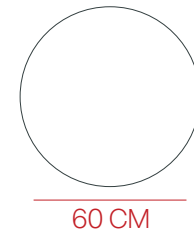

Leg base of 35 x 38 cm

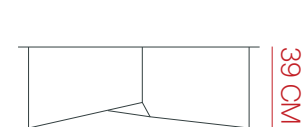
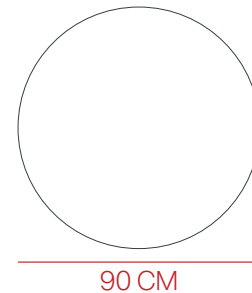

Leg base of 50 x 38 cm



LC-21-1260 / 6060

LC RECTANGLE

“

The LC rectangle table masterpiece effortlessly blends form and function. Its sleek, clean lines and minimalist design, crafted from premium materials, makes a bold statement in any contemporary setting. The table's robust steel base, paired with a smooth glass top, creates a striking contrast that adds a touch of sophistication to any space.

”

DIMENSIONS :

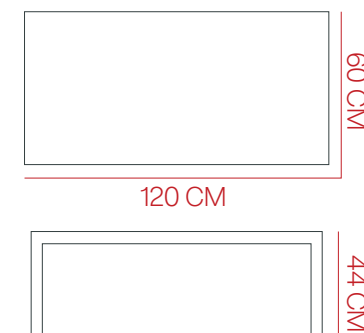
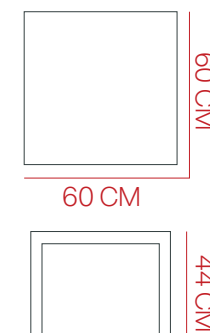



The Seating range offers a comprehensive solution for diverse seating needs. This collection combines ergonomic design, durability, and aesthetic appeal to provide optimal comfort and support. With a wide range of adjustable features and stylish options, the Seating range elevates workspace efficiency and enhances overall well-being.

SEATING

RANGE

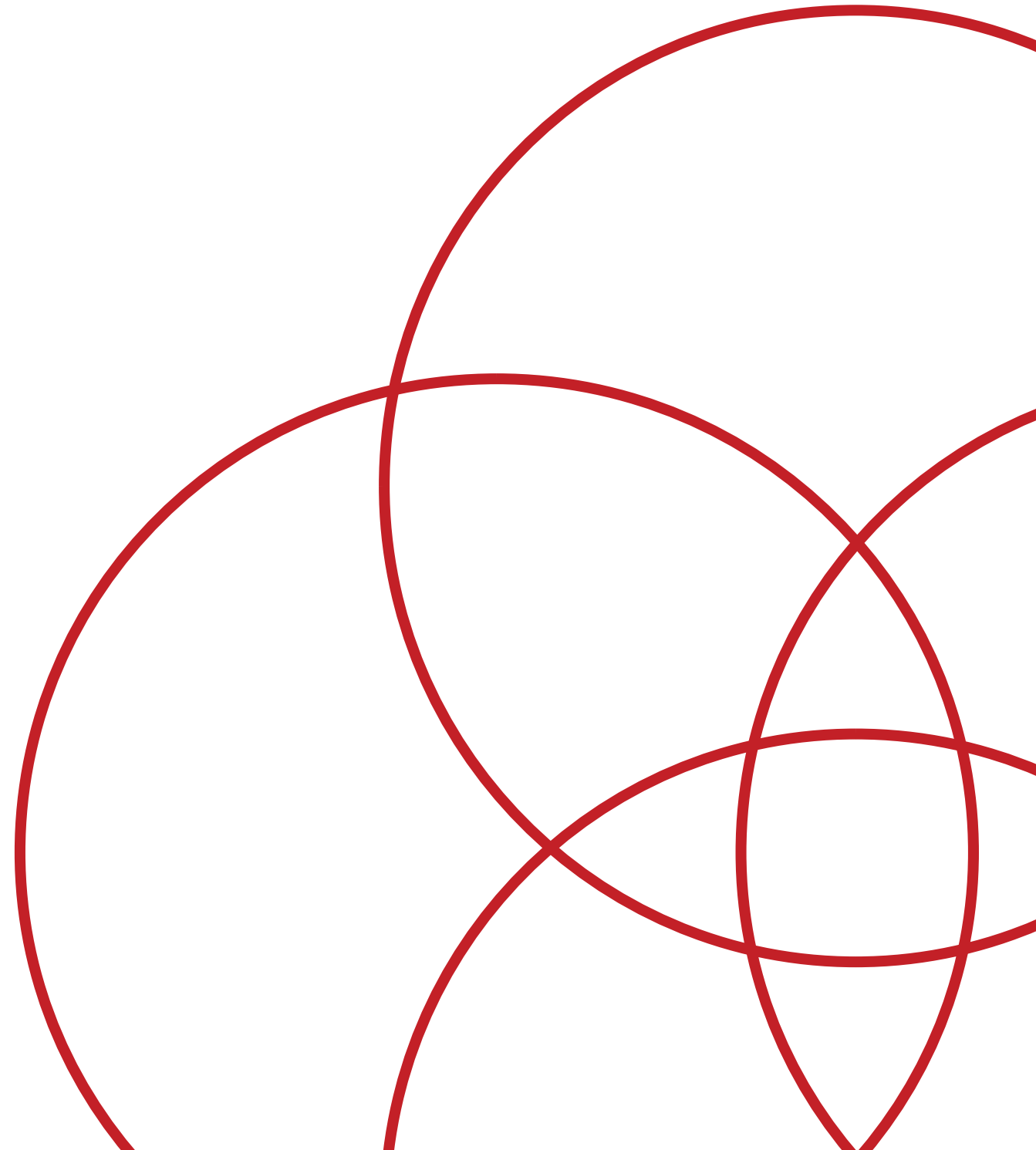



VERONA

/ SOFT SEATING

“

The Verona collection is designed for different spaces and can match various interior designs. It's beautifully upholstered in an extensive range of fabric and leather finishes to enhance any room's decor and ensure that it reflects personal style. It includes essential base components, ensuring stability and uniformity across all seating options. The base options are painted steel legs or stainless steel accents, effortlessly merging elegance with functionality.

”



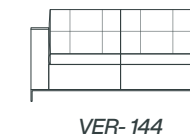

This sofa provides ample seating with an elegant design that complements contemporary interiors. Measuring 146 cm in length, 85 cm in depth, and standing at 62 cm in height, it's ideal for comfort and style.

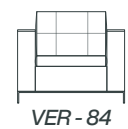

Verona Collection offers a compact and stylish seating solution with dimensions of 86 cm in length, 85 cm in depth, and a height of 62 cm. This piece brings a cozy yet sophisticated touch to any room.





VERONA ABACUS

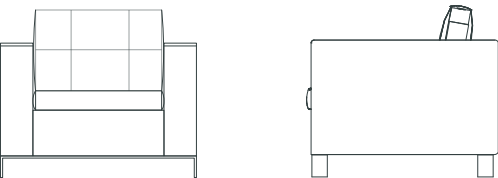

VER- 84 - SS/M - L/F - Color
L 86
D 85
H 62

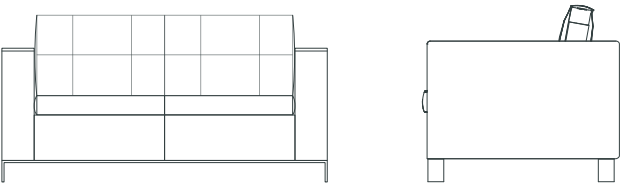

VER- 144 - SS/M - L/F - Color
L 146
D 85
H 62

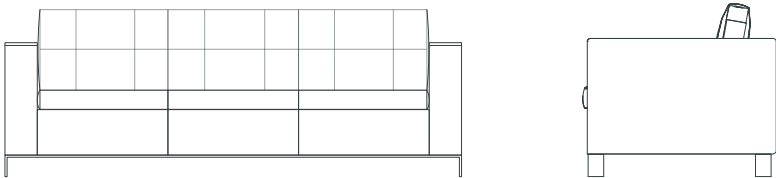

VER- 204 - SS/M - L/F - Color
L 206
D 85
H 62

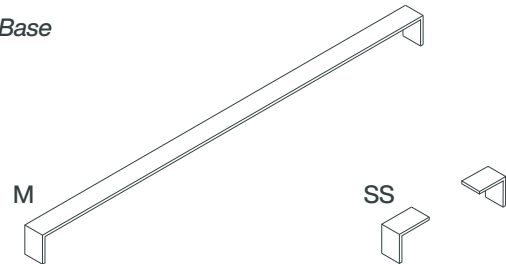



FLIP /SOFT SEATING

“

The Flip Modular Seating System is specially engineered to enhance comfort and adaptability in various environments. Its sleek aesthetic offers a modern touch while maintaining high functionality, making it the perfect addition to waiting areas, offices, and collaborative spaces.

”





The Flip collection offers contemporary upholstered detailing with a traditional touch. A block like form is softened enhancing the lumbar support

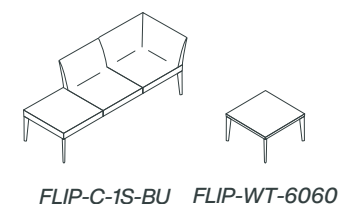

The modular components can be effortlessly rearranged and customized promoting collaboration and dynamic use of space.

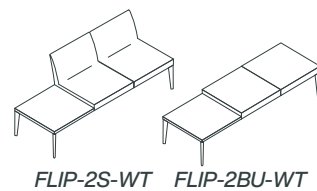

Flip collection has an endless selection of combinations of colours and fabrics that can be matched to fully involve sight and touch. Each module is topped with high-density foam to offer exceptional comfort for extended use.

FLIP ABACUS

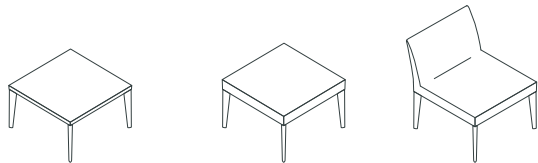

FLIP-WT-6060
L 60
D 60
H 35

FLIP-BU
L 60
D 60
H 42

FLIP-1S
L 60
D 60
H 42

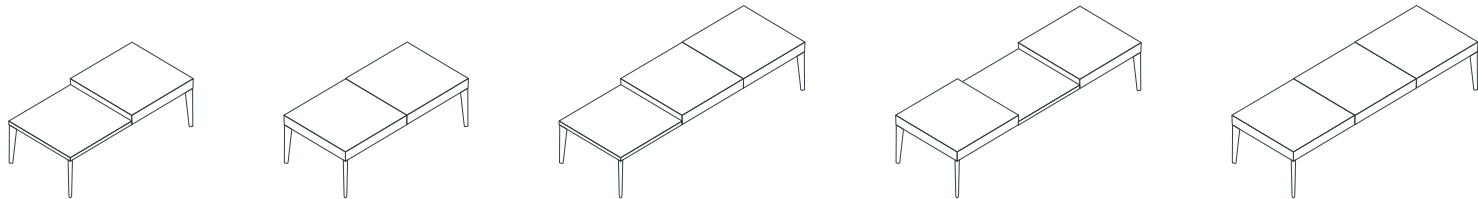

FLIP-BU-WT
L 120
D 60
H 42

FLIP-BU-WT
L 120
D 60
H 42

FLIP-2BU-WT
L 180
D 60
H 42

FLIP-BU-WT-BU
L 180
D 60
H 42

FLIP-3BU
L 180
D 60
H 42

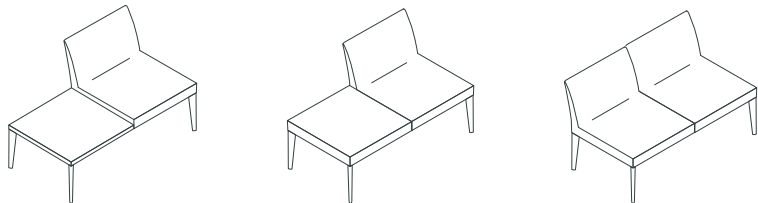

FLIP-1S-WT
L 120
D 60
H 42

FLIP-1S-BU
L 120
D 60
H 42

FLIP-2S
L 120
D 60
H 42

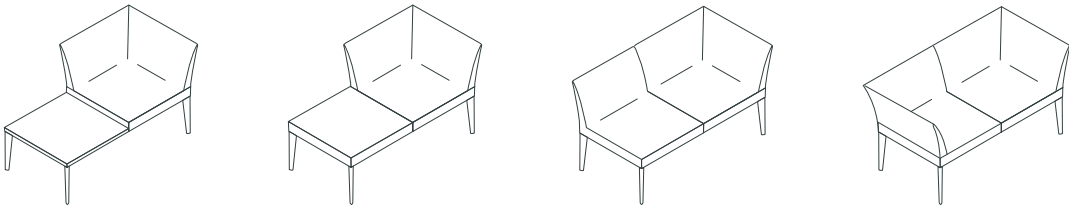

FLIP-C-WT
L 120
D 60
H 42

FLIP-C-BU
L 120
D 60
H 42

FLIP-C-1S
L 120
D 60
H 42

FLIP-2C
L 120
D 60
H 42

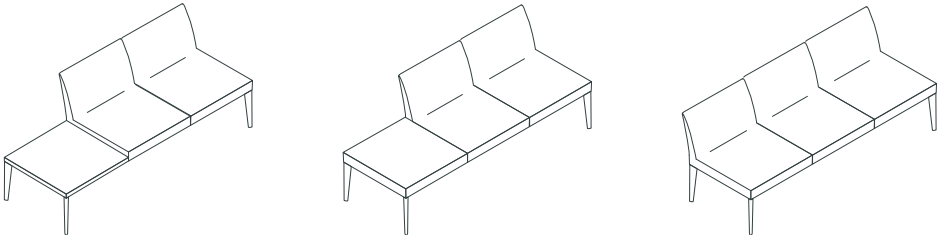

FLIP-2S-WT
L 180
D 60
H 42

FLIP-2S-BU
L 180
D 60
H 42

FLIP-3S
L 180
D 60
H 42

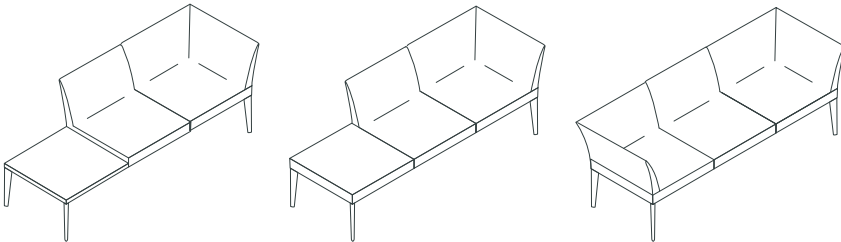

FLIP-C-1S-WT
L 180
D 60
H 42

FLIP-C-1S-BU
L 180
D 60
H 42

FLIP-2C-1S
L 180
D 60
H 42



ATOM / SOFT SEATING

“

The Atom is a contemporary seating solution designed to provide both comfort and style in lounge settings. It incorporates a durable frame that supports an ergonomic design, ensuring a cozy experience for users. Its upholstery can be customized with a variety of options, allowing it to fit seamlessly into diverse interior aesthetics. The Atom emphasizes both functionality and elegance, making it a perfect addition to any lounge area.

”







ATOM - F - R13

SPECIFICATIONS:

Steel shell structure moulded in cold-cure polyurethane foam. Moulded polyurethane seat with two various base options.

Levels of Softness:

softer in the centre for optimal comfort and less soft on the sides for optimal upholstery results.

Centre to Centre Distance of Shell:

140 x 140 mm and 153 x 200 mm. Wood slats under the shell to staple the fabric.

Weight :

shell with seat 15 kg.

Overall Dimensions :

disassembled shell 0.50 m3.



ATOM ABACUS

Atom Lounge Chair



ATOM - F - R13
77
74
114

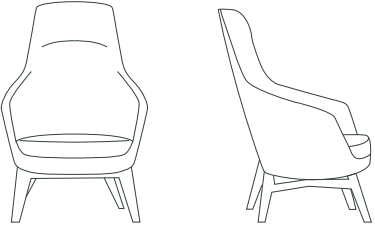

ATOM - F - R7
L 77
D 74
H 114



RIO / SOFT SEATING

“

Rio lounge chair tells a story of comfort and craftsmanship. An elegant design that is perfect for reflection, some solo-work or simply relaxation. With versatile upholstery options, Rio can fit any office aesthetic

”



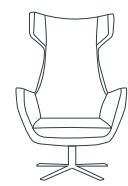

RIO - F - R13

Rio collection can be paired with a leg rest, providing an enhanced level of comfort and functionality. Additionally, it features a variety of upholstery options, allowing for customization to meet individual tastes.



SPECIFICATIONS:

Steel shell structure moulded in cold-cure polyurethane foam. Moulded polyurethane seat with three various base options.

Levels of Softness:

softer in the centre for optimal comfort and less soft on the sides for optimal upholstery results.

Centre to Centre Distance of Shell:

140 x 140 mm and 153 x 200 mm. Wood slats under the shell to staple the fabric.

Weight :

shell with seat 15 kg.

Overall Dimensions :

disassembled shell 0.50 m3.



R13



L10



R7

The collection is available with three optional alternative base options, including aluminum and wood, offering clients a range of choices to suit their preferences.

RIO ABACUS

Rio Lounge Chair



RIO - L / F / AL - R13

L 77
D 74
H 114

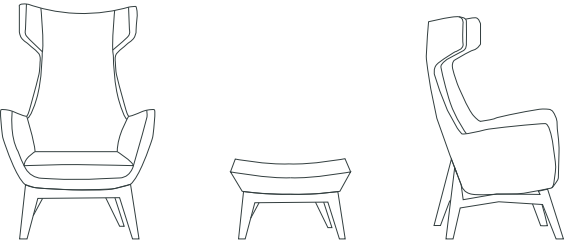

RIO - L / F / AL - L10

L 77
D 74
H 114



RIO - L / F / AL - R7

L 77
D 74
H 114



RUBIX / SOFT SEATING

“

Rubix is a modular pouf system designed for maximizing comfort and flexibility in waiting spaces. Its simple design allows for endless customization, making it easy to combine modules and accessories to create unique and functional solutions.

”



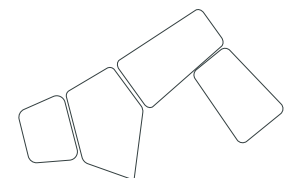

One of the key features of Rubix is its modular design, which allows for infinite customization. Each module is designed to be interdependent, with each piece working together to create a cohesive and harmonious whole. The result is a space that is both functional and aesthetically pleasing.



SPECIFICATIONS:

The Rubix Poufs feature a solid wood structure, providing a strong yet fun foundation for the seating solution.

The top is constructed from plywood, topped with a 50mm layer of soft foam.

The sides are wrapped with a 15mm layer of soft foam.

The base can be either plastic or wheels.

Material Options :

Leather or fabric upholstery

A combination of both leather and fabric



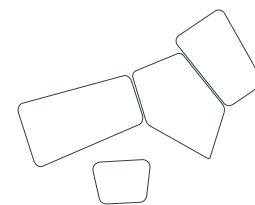

The collection features a range of seating modules in various shapes and sizes, all designed to be easily combined and rearranged to suit different needs and preferences. The possibilities are endless.

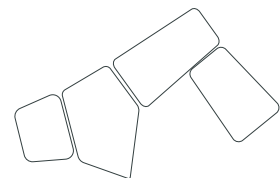

Rubix poufs can be crafted in a variety of materials, including leather and fabric, offering a range of options to suit different tastes and styles.

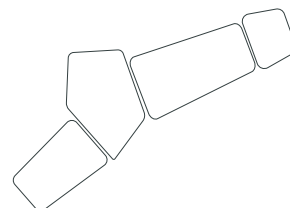

The modular design also makes it easy to repair and disassemble components, ensuring that the system remains functional and durable over time.

RUBIX ABACUS

Rubix Pouf

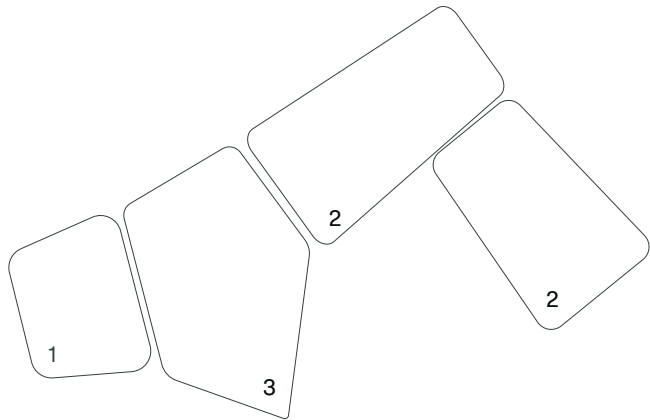

RUBIX - POUF1 - 5745

L 57
D 45
H 45

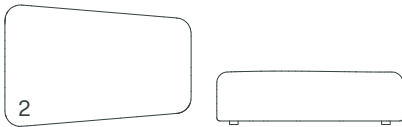

RUBIX - POUF2 - 12078

L 120
D 78
H 45

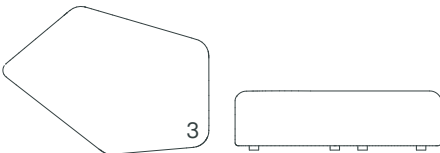
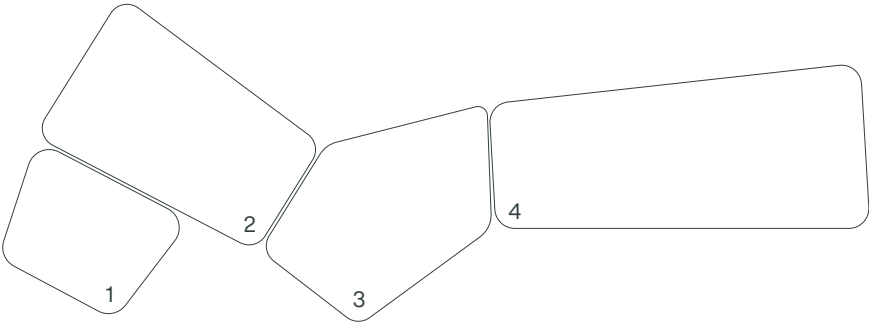

RUBIX - POUF3 - 12086

L 120
D 86
H 45

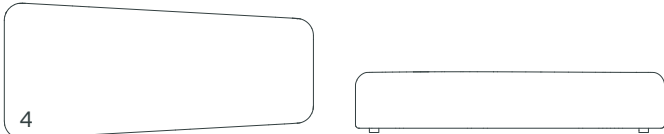

RUBIX - POUF4 - 18078

L 180
D 78
H 45



SWAY / SOFT SEATING

“

Sway is a modern masterpiece of seating design, combining minimalist aesthetics with unexpected comfort. Its unique, curved shape and low profile create a sense of calm and relaxation, while the contrasting textures of the upholstery and metal base add visual interest. Sway is perfect for creating a stylish and inviting atmosphere in any space

”



Crafted from premium solid wood. Generously padded with high-density foam, the sofa ensures exceptional comfort, while its curved silhouette creates a warm, inviting atmosphere. Customers can choose from a wide range of upholstery options, including luxurious fabrics, durable performance materials, and premium leather, allowing the sofa to adapt seamlessly to different styles and settings.

Ideal for living rooms, lounges, or reception areas, this sofa celebrates the harmony of nature-inspired design and modern comfort.

Dimensions:

W.217 D.72 H.74 S. H. 74

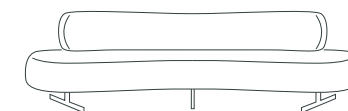

LS-007







TOKYO / SOFT SEATING

“

The Tokyo is a stunning example of mid-century modern design, combining sleek lines, tapered legs, and diamond-quilted upholstery. The sofa and armchair offer a harmonious blend of comfort and style, making it the perfect centerpiece for any contemporary living space

”



Tokyo is a modern molded foam sofa combines comfort and durability in a sleek, minimalist design. The sofa features a precisely contoured, molded foam body that provides exceptional ergonomic support while maintaining a lightweight profile. Encased within the foam is a sturdy metal insert, ensuring long-lasting structural integrity and resistance to wear over time.

The seamless design highlights clean lines and smooth surfaces, making it an ideal addition to contemporary spaces. Upholstered in a premium fabric or leather finish, this sofa offers both aesthetic versatility and tactile luxury. Perfect for waiting areas, offices, or collaborative workspaces, it embodies functional elegance and timeless style.

Dimensions:

Sofa :	W.184	D.81	H. 82	S. H. 42
Arm-Chair :	W.86	D.66	H. 86.5	S. H. 42

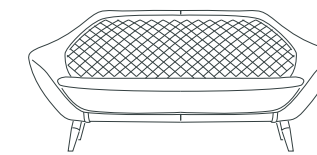

TOKYO-SOFA-S

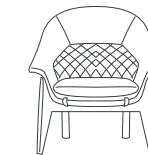

TOKYO-CH-WD





TOKYO-SOFA-S



TOKYO-CH-WD



VENICE

/ SOFT SEATING

“

The Venice offers a versatile seating solution for any modern living space. The set includes a two seater sofa and an armchair, both upholstered in a luxurious fabric with contrasting accents. The sleek metal legs add a touch of contemporary elegance that creates a stylish and inviting atmosphere.

”



Combining timeless craftsmanship with modern elegance, offering a versatile seating solution for compact spaces. The sturdy frame is made from premium solid wood for exceptional durability. The plush, high-density foam cushions ensure superior comfort, making it perfect for both casual lounging and formal seating.

A sleek stainless steel leg base adds a contemporary touch, providing stability and a polished aesthetic. With various upholstery options, including rich fabrics, performance textiles, and luxurious leather, this set can be customized to suit any decor style striking the perfect balance between style, comfort, and functionality.

Dimensions:

Sofa :	W.150	D.80
Arm-Chair :	W.90	D.80

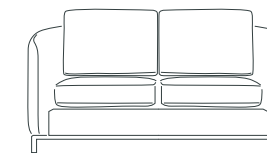

VNICE-55-2

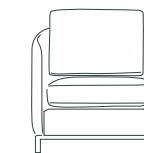

VNICE-55-1





VNICE-55-1





Seating Finishes



SEATING FINISHES

Fabrics & Leather

Category A

FABRICS
ASCOT

RF001

TAUPE 09 (L.GREY)

RF002

ATLANTIC 16 (BLUE)

RF003

GRAPHITE 11 (D.GREY)

FABRICS
OXFORD

RF004

RED

FABRICS
BRISTOL

RF005

ANTHRACITY (BLACK*WHITE)

RF006

MARSALA (RED*WHITE)

FABRICS
BROOKLYN

RF007

TRUFFLE (BEIGE)

RF008

CEMENT (L.GREY)

RF009

ANRKET (D.GREY)

RF010

BOKYL (L.GREEN)

LEATHER
SANTANA

RL001

005 (L.BEIGE)

RL002

310 (HAVAN ORANGE)

RL003

340 (D.GREEN)

SEATING FINISHES

Fabrics

Category B

FABRICS
KOYA

RF011

1 (L.BEIGE)

RF012

5 (BIEGE)

RF013

10 (L.GREY)

RF014

15 (D.BIEGE)

RF015

12 (D.GREY)

RF016

20 (BROWN)

RF017

22 (DUSTY YELLOW)

RF018

23 (LEMON GREEN)

RF019

51 (BLUE)

FABRICS
BALTIMORE

RF033

TOFFEE

RF034

KAKY

RF035

ELEPHANT

SEATING FINISHES

Fabrics

Category B

FABRICS

MUSA



RF020
MIX BROWN



RF021
BLACK



RF022
WHITE



RF023
MUSTARD YELLOW



RF024
ORANGE



RF025
RED



RF026
BLUE



RF027
NEW GREY (L.GREY)



RF028
D.GREY



RF029
SAND (D.BEIGE)



RF030
YELLOW



RF031
GREEN



RF032
NATA (OFF WHITE)

FABRICS

KENYA



RF036
ASH 13 (L.GREY)



RF037
ASH 14 (D. GREY)

SEATING FINISHES

Leather

Category B

LEATHER

TK



RL004
603 (L.GREY)



RL005
277 (RED)



RL006
006 (BEIGE)



RL007
345 (D. BROWN)



RL008
601 (D. GREY)



RL009
901 (BLACK)

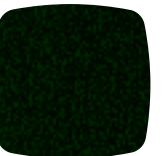

RL010
425 (D.GREEN)

LEATHER

SG



RL015
360 (LBROWN)



RL016
370 (BROWN)



RL017
380 (TOFFEE)



RL018
005 (BEIGE)



RL019
606 (D.GREY)

LEATHER

GLS



RL011
1068 (BLUE)



RL012
1032 (H-AVANI)



RL013
17 (D.GREY)



RL014
917 (RED)

SEATING FINISHES

Fabrics
Category C

FABRICS
SABIA

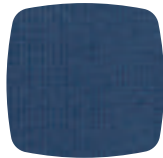

RF041
219 (NAVE)



RF042
1780 (YELLOW)

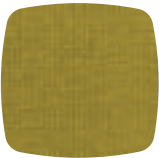

RF043
1945 (GREEN)



RF044
1859 (MANDRINE)

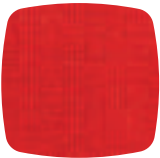

RF045
1815 (RED)



RF046
1002 (METAL-L.GREY)



RF047
1989 (STEEL-D.GREY)



Executive Chairs

/ SEATING

Our executive chairs collection is designed to bring unparalleled comfort, style, and sophistication to your workspace. Crafted with precision and innovation, each chair in our collection combines ergonomic features with luxurious materials to support productivity and enhance your professional environment. Our chairs offer a perfect balance of functionality and elegance, ensuring that every seating experience is both comfortable and reliable. Transform your office into a space that reflects your success and professionalism.



NUMEX



A modern take on the classic lounge chair, Numex delivers adjustability, ergonomics and contemporary comfort. Designed by an award winning ergonomic seating designer, Numex draws inspiration from the classic lounge chair styling. The aluminium frame provides functional strength, visual simplicity and gives a lightweight appearance. The upholstered arm pads and wood or gunmetal style frame delivers balance, elegance and comfort. The chair provides adjustable comfort with its clever recline mechanism with built-in lumbar tracking, auto-return positioning and recline memory lock. With a matching task and visitor chair, Numex looks great in any domestic or work space.

Dimensions:

W.83 D.75.5 H. (90-95) (113-126)



NUMEX-TTB-HAM



NUMEX-TTB-LAM



FEATURES :

Available as Lounge , Task or Visitor chair.

Aluminium one piece 4 or 5 star base.

Rotating bar.

Recline system.

Adjustable armrest.

Engineered frame.

Adjustable headrest.

Top grain leather arm pad.

High density supporting molded foam.

High-tech mesh support.

High density supportive memory foam.

Temperature adjust tech foam.

Top grain leather upholstery.



NUMEX-TTB-HAL



NUMEX-TTB-LAM



NUMEX-EP-HAL-B-R



NUMEX-TTB-HAL



NUMEX-TTB-HAL





NUMEX-EP-HAL



NUMEX-TWN-HAL

REGAL



Regal makes an impressive statement with its striking linear contours and beautifully balanced proportions, effortlessly blending style and functionality. Its advanced chair mechanism features an individual weight setting, allowing for a customized sitting experience that prioritizes comfort and support. The elegant aluminum bridge connecting the armrest to the seat support enhances the chair's sophisticated aesthetic, while the understated presence of the mechanism emphasizes its classic character. Crafted with meticulous attention to detail, Regal showcases a commitment to excellence through the use of premium materials such as durable PU leather and sturdy aluminum, ensuring both timeless elegance and long-lasting quality that stands the test of time.

Dimensions:

High :	W.70	D.50	Back H. 80
Mid :	W.68.5	D.54	Back H. 62



2022-HI



2022-MID





2022-HI



2022-VIS-C



2022-MID

ELEGO



The Elego is a perfect blend of modern design and ergonomic comfort. It's ideal for professionals seeking to enhance productivity and visual appeal in their office environments. Its sleek silhouette and luxurious quilted leather upholstery create a striking visual impact, while the adjustable features ensure optimal support throughout the day.

Dimensions:

W.57.5 D.60 Back H. 77



OA-1365





OA-1365



RONIN



Timeless elegance characterizes the beauty of Ronin, an office chair dedicated to demanding decision-makers who seek comfort and refinement at the highest levels. This seat reveals a particular silhouette, originating from studies and planning aimed at combining aesthetics and functionality into one. The quality of its production is inserted as a guarantee of a product that is difficult to replicate and destined to last over time. Available in different models including executive, managerial, and meeting. The upholstery is embellished with tone-on-tone or contrasting stitching.

Dimensions:

W.70 D.60 Back H. 95



MASTERO



Mastero is crafted with premium leather upholstery with a sturdy wooden frame, offering both style and comfort. Its ergonomic design and adjustable features ensure optimal posture and support making it a valuable addition to any workspace.

Dimensions:

High :	W.62.5	D.64	Back H. 80
Mid :	W.59	D.64	Back H. 61

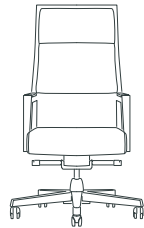

RI601-Hi

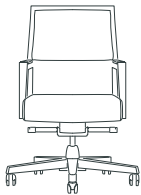

RI601-MID



BJ



The BJ embodies classic elegance and timeless design, making it a perfect addition to any sophisticated workspace. This high/mid back leather chair is upholstered in premium leather, featuring a rich black leather-look finish that adds a touch of luxury. Designed for exceptional comfort, it includes sturdy V-shaped fixed armrests that provide support without compromising the chair's refined lines. The advanced synchro gaslift mechanism allows for smooth height adjustments and any-angle locking, while the synchronised mechanism features five lockable positions to accommodate your preferred seating posture. For further customization, the body weight tension can be easily adjusted using a convenient knob located under the seat. The BJ Chair is supported by a robust 5-star black nylon base with 50mm nylon castors, ensuring both stability and effortless mobility, ideal for those seeking comfort and style throughout their workday.

Dimensions:

High :	W.66	D.60	Back H. 77
Mid :	W.59.5	D.54	Back H. 57



BJ015-H

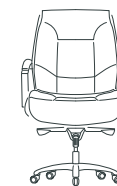

BJ015-M



BJ015-V





BJ015-V



BJ015-H



BJ015-M

FURRICO



The simple structure and lines requires high design capacity to create enduring beauty. The meticulous measurement and repeated modification of lines and proportion in design originates from persistence in profession, which is also the important force to push good works from backstage to stage. The Furrico respects tradition and is full of freshness, which brings surprise to market.

Dimensions:

F181:	W.97	D.60	H. 64
F281:	W.97	D.60	H. 50

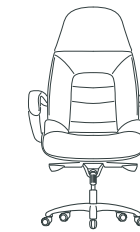

F181



F281





F281



F181



ERGOHUMAN ELITE G2



Ergohuman Elite G2 is specifically designed for workers who need a comfortable office chair for intensive use. Its flex zones ensure continuous support for the back and lumbar region, while the adjustable armrests relieve pressure on wrists, arms, and shoulders. Additionally, the height-adjustable pivoting headrest helps reduce neck strain.

Engineered with a dual pivot mechanism that includes recline position locking, seat slide, a forward synchro tilt seat, and seat height adjustment, the Ergohuman Elite G2 also features an automatic lumbar support system with precise tension adjustment, adjustable arms, and an optional headrest. The Elite model can also be upgraded to a Plus version, which includes a recline limiter function and additional aluminium detailing.



EHS-HAM



EHPL-AB-HAM-LM



ERGOHUMAN ELITE G2 FEATURES

FEATURES :

Dual pivot, synchro mechanism

Right single lever for:

- Seat height (90 mm)
- Seat slide (50 mm)
- Lockable back tilt

Left lever for forward seat tilt

Recline tension control

Back height adjustment (65 mm)

Integrated lumbar support with tension control

- Height, width, depth, angle and armpad tilt

Waterfall seat front

Polished aluminium base with 60 mm castors

OPTIONS :

- Black or grey frame
- Adjustable headrest
- Fold-out footrest
- Pop-up coat hanger
- Plus upgrade with recline limiter and enhanced aluminium detailing





ERGOHUMAN ELITE G2 DIMENSIONS



DIMENSIONS

- Overall height : 1180-1370
- Overall depth : 675
- Overall width : 670-700
- Base diameter : 675
- Seat height : 500-600 (range 100)
- Seat depth : 490-540 (range +50)
- Seat width : 510
- Back width : 520
- Backrest height : 550
- Seat to top of back : 580-640 (range 60)

WEIGHT LOADING

Warrantied for use by persons up to 150 kg.

- Armheight from seat : 175-275 (range 100)
- Armrest width range : 15 + 15
- Armrest depth : 285 (range +40)
- Armrest angle : 60° in/10° out
- Armpad tilt : 42°

OPTIONAL

- Headrest stem height : range 75
- Headrest angle : range 35°
- Legrest extension : 400



EHPL-AB-HAM-LM

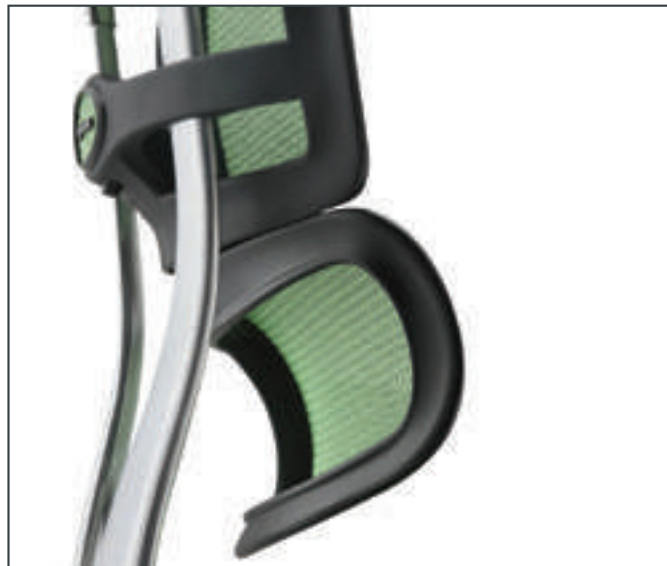

CERTIFICATION

- BS5459-2:2000+A2:2008
- EN1335-1:2020
- EN1335-2:2018
- ANSI/BIFMAX5.1-2017
- GREENGUARD GOLD

Greenguard Certification Standards have established performance-based standards to define products and processes with low chemical and particle emissions for use indoors.



EHS-HAM

RECYCLABILITY



MATERIAL ANALYSIS

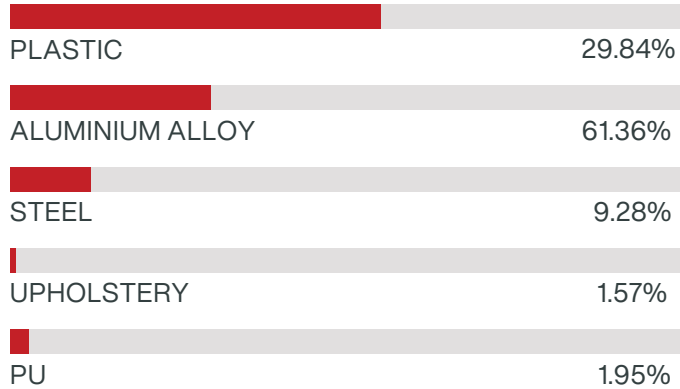

RECYCLED CONTENT



FINISHES

T MESH



BLACK STANDARD
T-168-B1



LIGHT GREY
T-168-B2

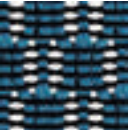

COBALT
T-168-B4

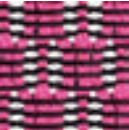

PINK
T-168-B5



GREEN
T-168-B6



SCARLET
T-168-B3

W MESH



BLACK
W09-01

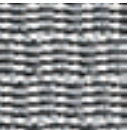

WHITE
W09-24

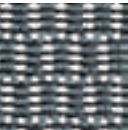

GREY
W09-24

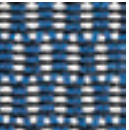

BLUE
W09-01

ERGOHUMAN LUXURY G2 FEATURES

Ergohuman Luxury 2 is a high luxury ergonomic chair ingenuity with a 12D sitting sensation, stronger support, more comfortable sitting. Equipped with the super drift backward linkage unloading force chassis, it can achieve the feet are not tilted, the legs are not pushed, the waist and the head pillow support position is unchanged, the silky soft and smooth backward to the end, and the help is not difficult to get up.

FEATURES :

Single lever adjustment.

Tension control.

Tilt lock.

Automatic lumbar support.

Synchro-tilt mechanism.

Seat height adjustment.

Waterfall seat.

Back height adjustment.

Seat depth adjustment.

Arm height depth & swivel adjustment.

Optional headrest with height and angle adjustment.

Optional coat-hanger.



EHL2-AB-HBM-L-5D-D-LM



GENIDIA



The Genidia mesh office chair offers all users superior comfort, flexibility, and ergonomic support with streamlined elegance and perfect balance of form and function. Combined with the exceptional dynamic movement and posture warning device, this collection promotes a healthier workforce, enhanced productivity, and overall workplace well-being.

Genidia boasts 94% recyclability, has Greenguard Gold Certification, and meets EN 1335 1, 2, and 3. It is available in various mesh finishes and different base colors.

Dimensions:

W.71 D.59 H.87

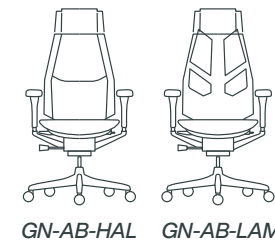

GENIDIA FEATURES

FEATURES

- Black and polished fram.
- Full synchro tilt mechanism.
- 2D matrix - backrest pressure sensors.
- Spinal-flex support.
- Five point back height adjustment.
- Lumbar support with tracking system.
- Intuitive single lever control.
- Lift and lower forward seat tilt.
- Single finger control tension.
- 4D height, width, depth and angle adjustable arms.
- Seat depth roll adjustment.
- Posture warning device.
- Polished aluminium five star base.

OPTIONS

- Multi-directional headrest
- Legrest
- Available in mesh, and leather with mesh perimeter





GN-AB-LAM





GN-AB-HAL



GN-AB-HAL



CERTIFICATION

- EN1335-1
- EN1335-2
- EN1335-3
- ANSI/BIFMAX5.1-2012
- GREENGUARD GOLD

Greenguard Certification Standards have established performance-based standards to define products and processes with low chemical and particle emissions for use indoors.



RECYCLABILITY



MATERIAL ANALYSIS

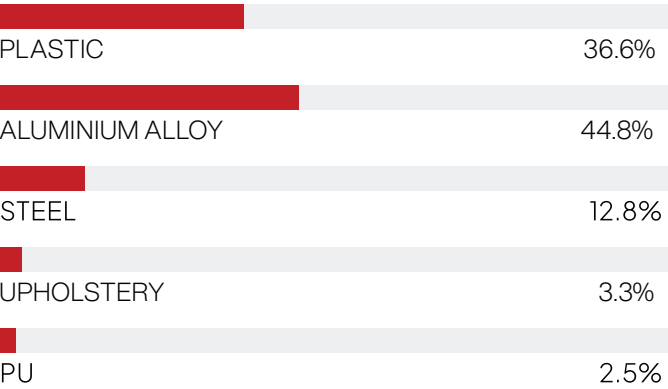

RECYCLED CONTENT

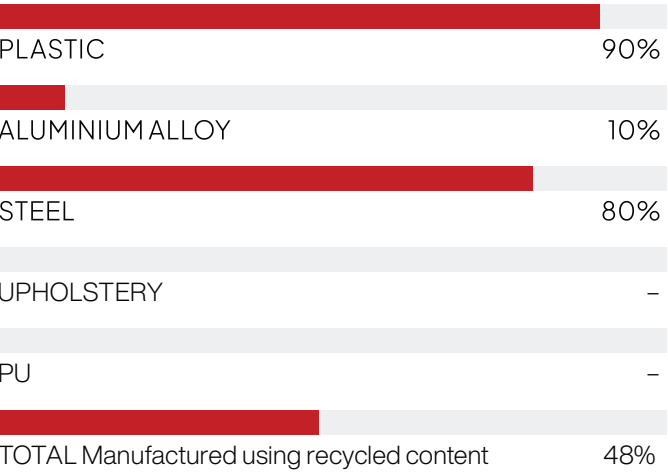

FINISHES

W MESH

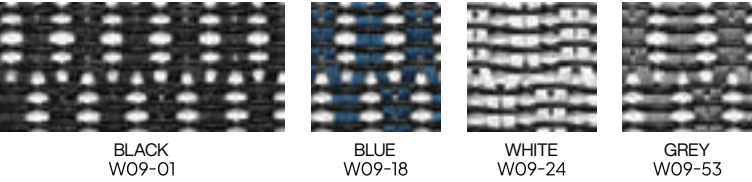

KMD MESH



LEATHER





Task Chairs

/ SEATING

The Task Chairs showcases a diverse range of modern and ergonomic seating solutions designed to enhance comfort and productivity. From sleek, minimalist designs to high-back executive chairs with advanced features, these mesh chairs offer a perfect blend of style and functionality. Whether you're seeking a chair for a home office, a corporate setting, or a creative workspace, this collection has something to suit every need and preference.



ENJOY ELITE G2



The Enjoy Elite G2 model features unique autoflex zones for back and lumbar support; an ingeniously simple single lever which operates the three most frequently used chair functions (seat height, seat slide and back tilt); and an additional lever on the left to control the new forward seat tilt function.

The integrated lumbar support now includes tension control for customised support, and the armrests have been updated with an ergonomic tilt-up feature, ideal for mobile device or gaming users.

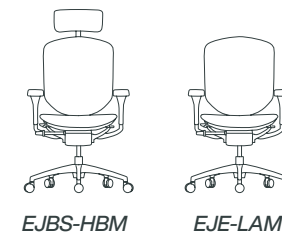

ENJOY ELITE G2 FEATURES

FEATURES

Synchro mechanism

Generous wide backrest

Right single lever for:

- Seat height
- Seat slide (50 mm)
- Lockable back tilt

Left lever for forward seat tilt

Recline tension control

Integrated lumbar support with tension control

5D adjustable armrests:

- Height, width, depth, angle and armpad tilt

Enhanced waterfall front seat

Polished aluminium base with 60 mm castors

OPTIONS

- Black or grey frame
- Adjustable headrest
- Fold-out footrest
- Choice of coloured mesh upholstery



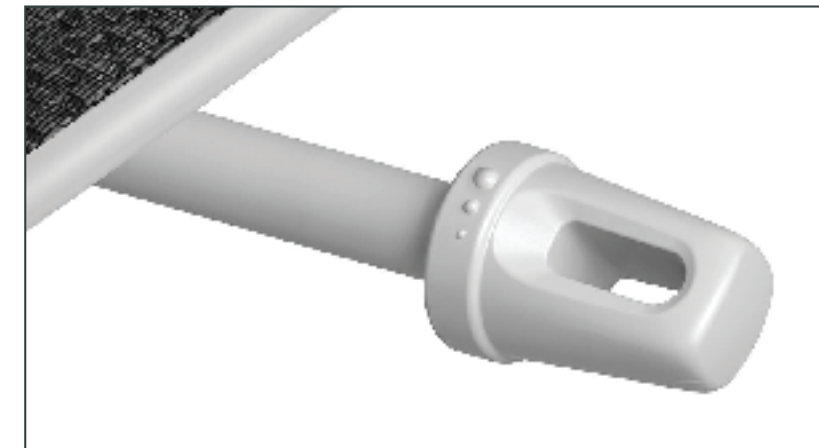

ENJOY ELITE G2 DIMENSIONS



DIMENSIONS

Overall height : 1150-1410

Overall depth : 675

Overall width : 650-680

Base diameter : 675

Seat height : 500-600 (range 100)

Seat depth : 490-540 (range +50)

Seat width : 510

Back width : 495

Backrest height : 590

Seat to top of back : 590-660 (range 70)

WEIGHT LOADING

Warrantied for use by persons up to 150 kg.

Armheight from seat : 150-250 (range 100)

Armrest width range : 15 + 15

Armrest depth : 285 (range +40)

Armrest angle : 60° in/10° out

Armpad tilt : 42°

OPTIONAL

Headrest stem height : range 75

Headrest angle : range 35°

Legrest extension : 400



EJBS-HBM



CERTIFICATION

- EN1335-1
- EN1335-2
- ANSI/BIFMAX5.1-2017
- GREENGUARD GOLD

Greenguard Certification Standards have established performance-based standards to define products and processes with low chemical and particle emissions for use indoors.



RECYCLABILITY



MATERIAL ANALYSIS

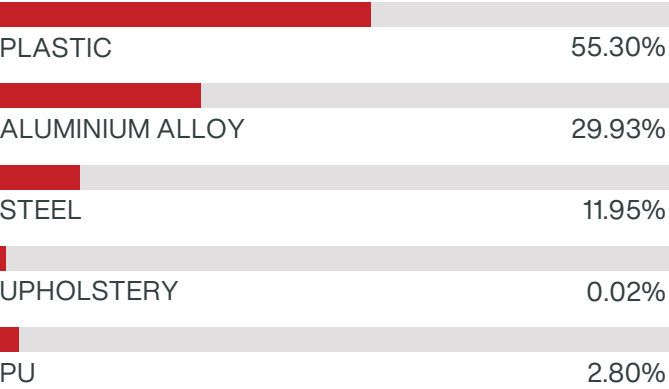

RECYCLED CONTENT

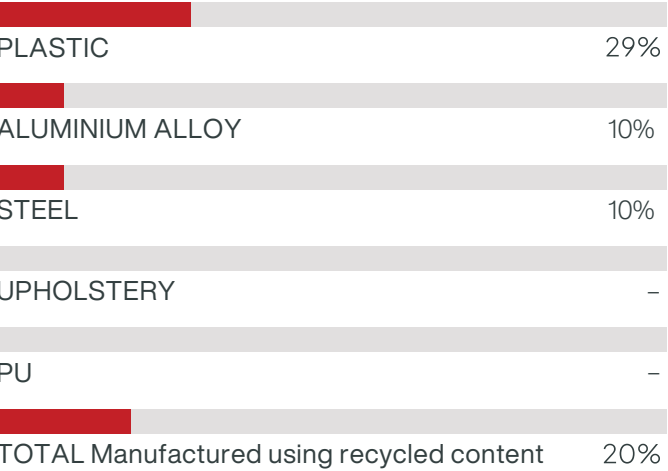

FINISHES

T MESH



W MESH

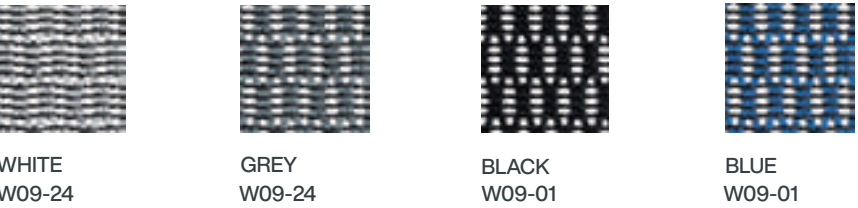

IOO ELITE G2



IOO-BA

The beauty of Project IOO lies in its simplicity. Designed to be one of the most intuitive chairs on the market, it delivers superb ergonomic value and flexibility. It's suitable for all users and the perfect solution for large organisations and for agile working environments.



IOO ELITE G2 FEATURES

FEATURES

Synchro mechanism

Right single lever for:

- Seat height
- Seat slide (50 mm)
- Lockable back tilt

Left lever for forward seat tilt

Recline tension control

Integrated lumbar support with tension control

Waterfall front seat

5D adjustable armrests:

- Height, width, depth, angle and armpad tilt

Polished aluminium base with 65 mm dual castors

OPTIONS

- Black or grey frame
- Adjustable 3D headrest
- Fold-out footrest
- Pop-up coat hanger





CERTIFICATION

- EN1335-1:2020
- EN1335-2:2018
- ANSI/BIFMAX5.1-2017
- GREENGUARD GOLD

Greenguard Certification Standards have established performance-based standards to define products and processes with low chemical and particle emissions for use indoors.



100-BA

RECYCLABILITY



MATERIAL ANALYSIS

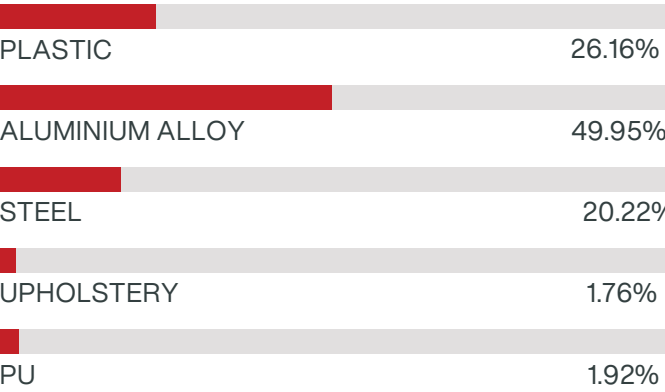

RECYCLED CONTENT

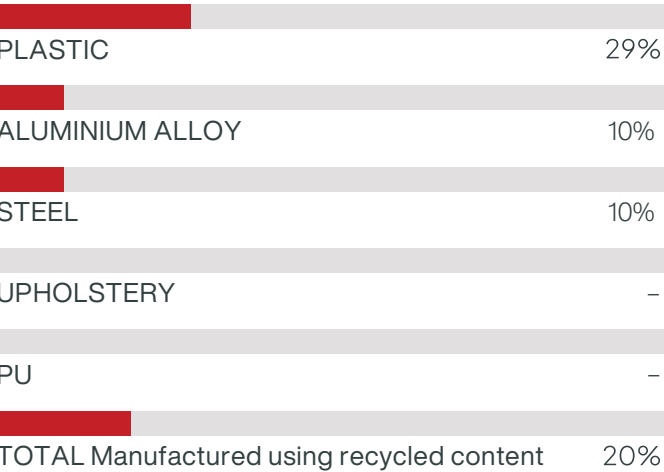

FINISHES

T MESH

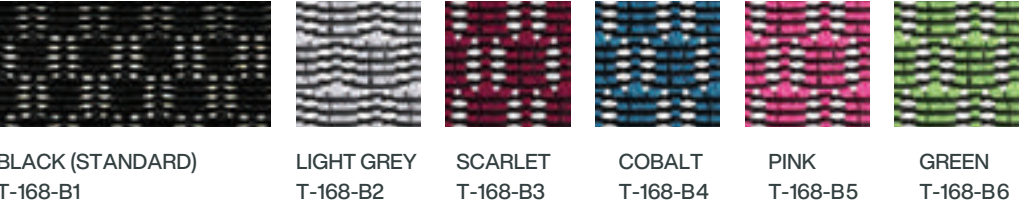

W MESH

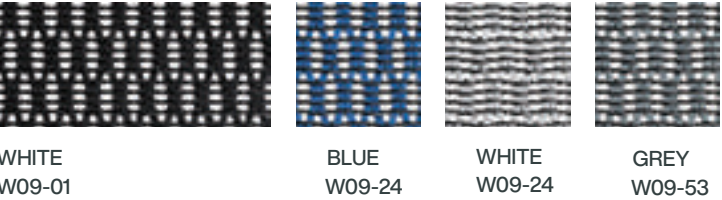

ERGOLIFT

Ergolift features a modern office chair designed for optimal comfort and support during long work hours. The chair showcases a breathable mesh backrest that promotes airflow and prevents overheating, while the adjustable headrest provides additional neck and head support. The contoured seat cushion, upholstered in a soft, breathable fabric, offers comfortable seating for extended periods. The chair's sturdy metal frame and five-star base with casters ensure durability and easy mobility around the workspace. The chair's sleek design and neutral color palette make it suitable for a variety of office settings.



A928-1



MODEX

Modex offers a balance of comfort and affordability. Its breathable mesh back and contoured seat provide essential support. The adjustable features, including the 3D armrests and slide mechanism, allow for customization. The BIFMA-certified gas lift and aluminum base ensure durability and stability



M33-HI



M33-HI



M33-LO

ASTRA

Astra is a premium ergonomic chair designed for maximum comfort and support. Its high-back design, adjustable armrests, and contoured seat offer a personalized fit. The weight-adjusted recline mechanism and smooth height adjustment allow you to tailor the chair to your preferences. With a sturdy base and smooth-rolling casters, the H65 is a versatile and stylish addition to any workspace.



H65



H65



H65

KAIRO

Kairo combines style and functionality. Its breathable mesh back and contoured seat ensure comfort, while the adjustable armrests and multi-function mechanism allow for personalized adjustments. The sturdy aluminum base and smooth-rolling casters provide stability and mobility. This chair is ideal for those seeking a modern and ergonomic seating solution.



H8567-LO



H8567-HI



H8567-LO

BREEZE

Breeze is designed to enhance your comfort and productivity. Its breathable mesh back keeps you cool, while the lumbar support promotes proper posture. The pneumatic seat-height adjustment and 360-degree swivel allow for easy customization and movement. The ergonomic design reduces pressure on your spine, and the armrests provide additional support. With non-marking casters and a sturdy star base, this chair offers both mobility and stability.



M6055W



M6055W



4U

The 4U Series features a breathable mesh backrest that promotes airflow and prevents discomfort during extended sitting periods. The chairs come in a variety of color options, including white, gray, and black, allowing for customization to suit different office aesthetics. The chairs are equipped with adjustable seat height and tilt mechanisms, ensuring optimal comfort and support for individuals of varying heights. The swivel base and casters provide effortless mobility around the workspace. The chairs' clean lines and contemporary design make them a stylish addition to any modern office setting.



4U-HI



4U-LO



ARCO

Arco is designed to provide optimal comfort and support. Its ergonomic design, featuring adjustable lumbar support and a breathable mesh backrest, promotes proper posture and reduces back pain. The reclining feature allows you to take a break and relax, while the adjustable seat height and armrests ensure a personalized fit. Arco is a versatile and stylish choice for any workspace.



M8053W



M8053G



M8053B

VISITOR

The visitor chair is a single-frame structure, suitable to be used in any context and environment. This collection of polypropylene shell is designed for multiple functions as it features a geometric pattern backrest that promotes airflow, preventing discomfort during extended sitting periods in addition to the seat cushion, that is available in different colors offers additional comfort. This chair is a perfect blend of style and functionality, making it ideal for any modern workplace.



T68-CH



T68-CH



T68-CH

V202

The V202 Chair is a stylish and functional seating solution. Its sleek design and chrome frame complement various interior styles, making it suitable for a range of settings, from reception areas to conference rooms. The breathable mesh back and comfortable seat ensure comfort, while the durable construction guarantees long-lasting performance.



V202



V202



V202



Stools & Multipurpose Chairs

/ SEATING

Our modern multi purpose stools and chairs collections offer a perfect blend of form and function, designed to smoothly integrate into any setting. With their sleek designs and versatile features, these stools are suitable for both contract and domestic environments.

Geometric shapes, contemporary designs, and a range of colors and finishes come together to provide a comfortable and practical seating solution. For added comfort, our stools can be customized with upholsterable panels, allowing you to tailor the look and feel to your unique needs.

Whether you're furnishing a modern living space, a trendy bar area, or a commercial setting, our stool collections offer a diverse range of options to meet your needs.



LII

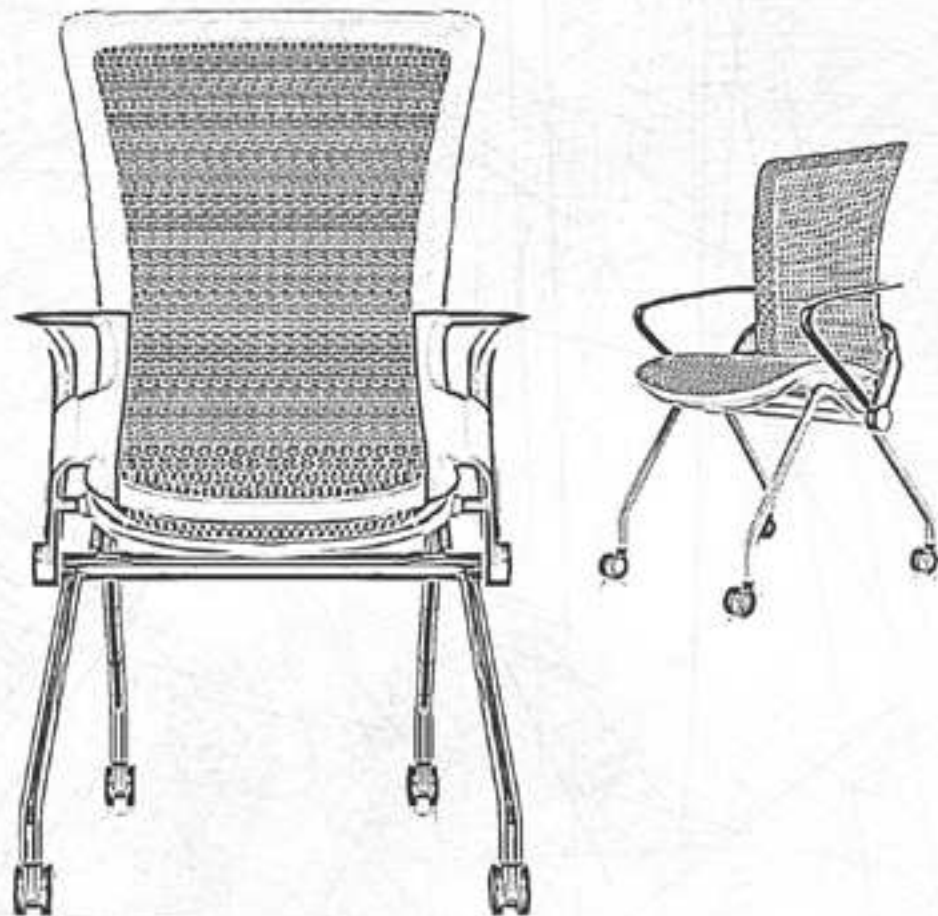

Lii offers a flexible range of lightweight and versatile guest seating with 4-leg mobile and cantilever legs styles to complement our range of mesh office chairs.

The Lii four-legged guest chair provides a sleek nesting solution for the design-led or space conscious environment and is available with castors or glides, while the cantilever guest chair is the perfect pull-up chair for meetings, guests, reception areas, conferences or breakout areas.

The Lii chair conforms to EN 1335-2 and -3, and has Green-guard Gold accreditation.



LII-N-WW-HAB-LBM-F

LII FEATURES

FEATURES

Body-responsive flexible back.

Lightweight design.

Fold-up seat for compact nesting on 4-leg model.

Waterfall seat front to promote healthy circulation.

Fixed ribbon armrests.

OPTIONS

- Cantilever or four leg with castors design
- Polished, black or white legs
- Black or white seat and back frame
- Choice of mesh upholstery



LIIN-WW-HAB-LBM-F



LIIG-BP-HAB-LAM-485



CERTIFICATION

- EN1335-2
- EN1335-3
- ANSI/BIFMAX5.1-2012
- GREENGUARD GOLD

Greenguard Certification Standards have established performance-based standards to define products and processes with low chemical and particle emissions for use indoors.



RECYCLABILITY



MATERIAL ANALYSIS

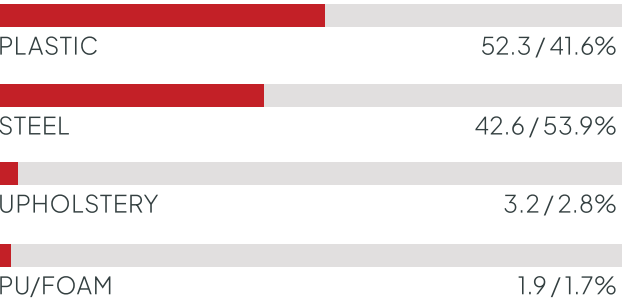

RECYCLED CONTENT

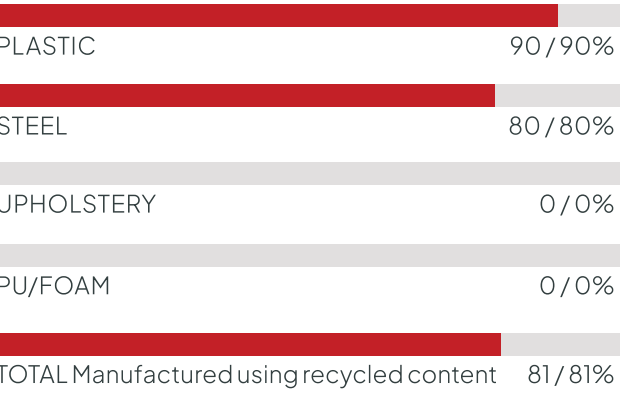

FINISHES

W MESH



BLACK (Standard)
W09-01



BLUE
W09-18

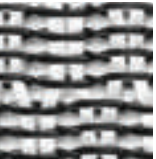

WHITE
W09-24

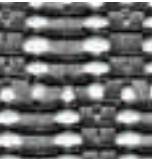

GREY
W09-53

KMD MESH



BLACK
KMD-31

RACE

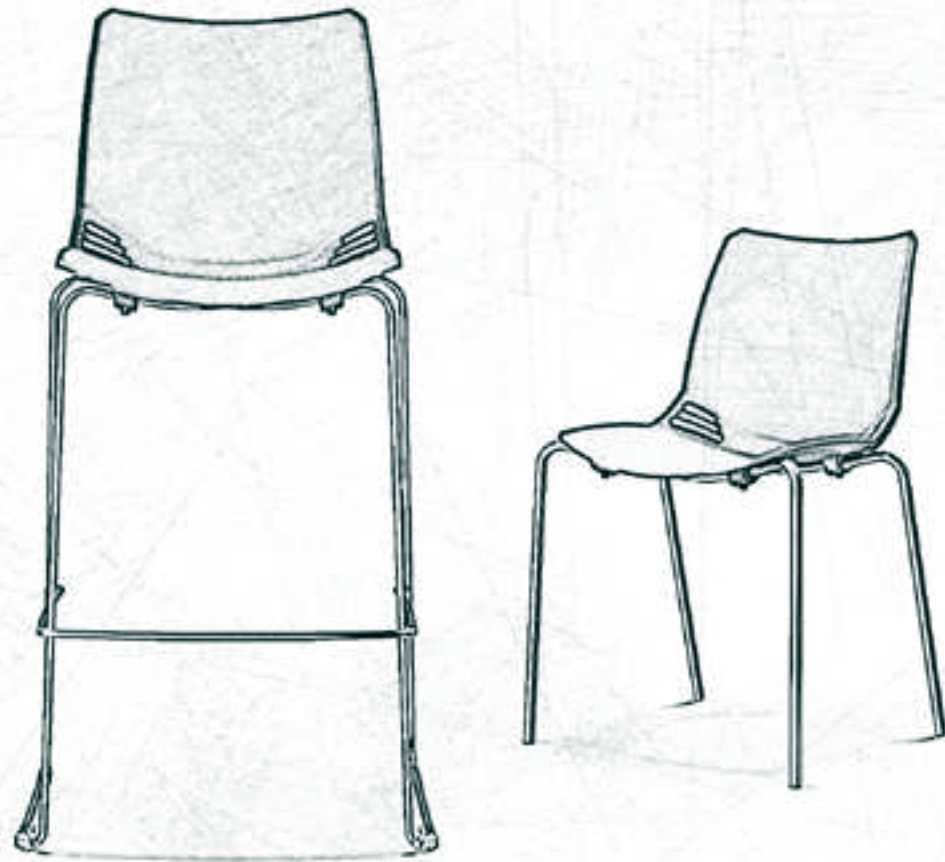

The Race stool is a functional and modern addition to any setting. Featuring a spacious seat with geometric, contemporary shapes, it is ideal for contract and living spaces. It features eight different shades for the plastic monoshell - including ivory, gray, yellow, red, orange, and blue - and offers different finishes for the sturdy sled frame, which has an integrated footrest. For additional comfort, a practical upholsterable panel can be added that can be easily installed on the seat.

Dimensions:

W.55.5 D.52 H.106



LIIG-BP-HAB-LAM-485



LIIG-BP-HAB-LAM-485



LIIG-BP-HAB-LAM-485



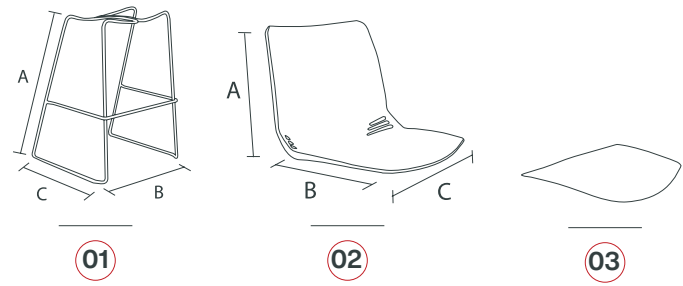

01 race-wire high bar stool for shell without caps

A	B	C
700	500	550

02 race-plastic shell model race

A	B	C
380	410	450

Finishes



The Race chair is characterized by its wide seat and geometric, contemporary shapes, making it an excellent choice for various environments. Available in eight vibrant shades for the plastic monoshell, including ivory, gray, yellow, red, orange, and blue, it offers various finish options for both the 4-leg and sled frames, both of which are stackable, as well as a swivel base. Additionally, the Race chair can also be customized with a stylish wire leg base, adding an elegant touch to its design while providing enhanced stability and a lighter visual profile. This wire leg option complements the chair's modern aesthetic and is perfect for settings where sophistication and contemporary flair are desired. For added comfort, an upholsterable panel can be easily installed on the seat, allowing for further personalization and style.

SIZE: W.53 D.51 H. 80



R-X1-H-73



R-X1-H-73



RACE-CH

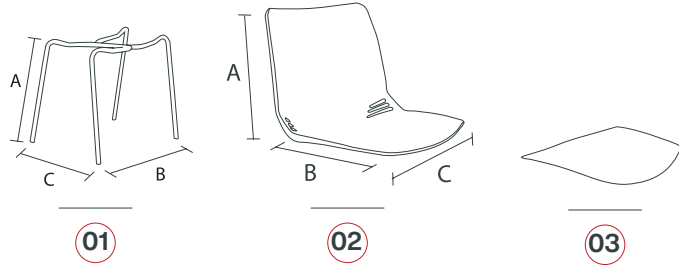

01 race-4 legs frame d.18 without caps

A	B	C
460	500	470

02 race-plastic shell model race

A	B	C
380	410	450

Finishes



MANILA



Manila offers the feeling of a secure embrace thanks to its enveloping armrests that are dynamically integrated into the backrest of the wide and comfortable plastic monoshell. The colors of the monoshell, available in 6 trendy shades, find the perfect match with the finishes offered for the 3 available frame variants.

Dimensions:

W.56 D.47.5 H.78.5



18.06.349.99A



18.06.349.99A



18.06.349.99A

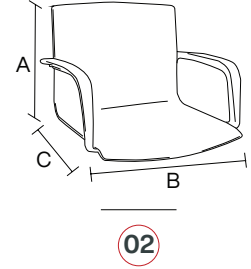
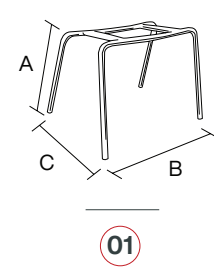

01 manila- legs frames d.22 without caps

A	B	C
445	585	490

02 manila-plastic shell with arms

Finishes

Shell :



Frame :



Manila is complemented with multiple leg base options, offering versatility and functionality. Each leg base option is designed to seamlessly integrate with the chair's overall aesthetic and provides practical utility, making the Manila an excellent choice for various applications.

The Manila 4-legs base provides stability and durability, and ensures long-lasting use while allowing for easy stacking when not in use.

The Manila swivel base enhances movement and accessibility, making it ideal for dynamic environments such as offices, and collaborative spaces

The Manila cantilever base adds a modern touch and allows for smooth movement, making the chair suitable for both indoor and outdoor use. This option provides a sleek profile while maintaining comfort and support.



18.06.351.99A



18.06.349.99A



MANILA-P1

DUETTO

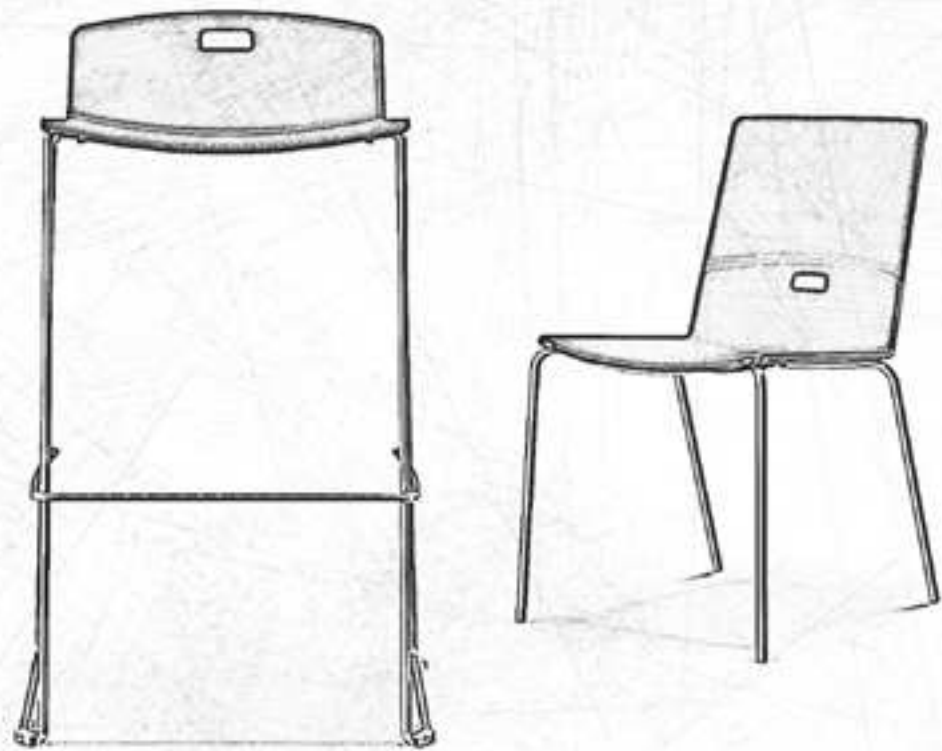

Available with sled frames in heights of 630mm or 730mm, the Duetto stool is suitable for both domestic settings and for matching with the most typical bar counters. Its low-backed plastic shell takes full advantage of the dynamic nature of the collection's interlocking assembled shell system, offering a practical handle ideal for easy handling.

Dimensions:

W.52.5 D.50 H. 63/73



217000800C



217000800C



217000800C

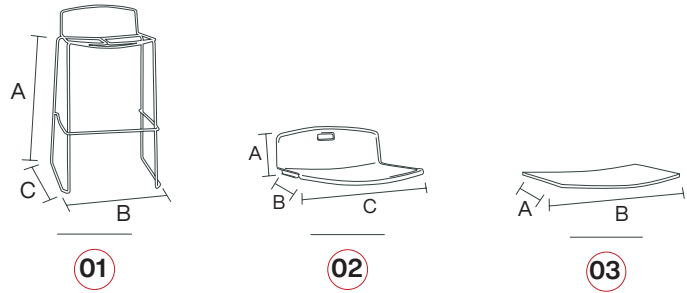

h.630 [01] duetto-wire high bar stool h.630 d.11

A	B	C
630	525	500

h.730 [01] duetto-wire high bar stool h.730 d.11

A	B	C
730	525	500

[02] duetto-plastic seat colored + pf1

A	B	C
180	390	430

A	B	C
180	390	430

[03] duetto-seat panel with 6 upholstery nail m6

A	B
395	410

Finishes



The Duetto chair showcases a complete selection of frames paired with a dynamic and functional plastic shell, distinguished by its innovative interlocking assembly system. It's available in a choice of five colors, the shells can also be configured with differing tones for the backrest and seat, allowing for further personalization. Additionally, customization options are enhanced with an upholsterable panel that can be added to the seat. Also, the Duetto chair is also offered with a stylish wire leg base, providing a sleek and modern aesthetic that complements its design while ensuring stability and durability. This option not only adds to the chair's unique character but also makes it suitable for a variety of settings.

Dimensions:

W.48 D.53 H.80



132202-022



132202-022



DUETTO-CH-GREY

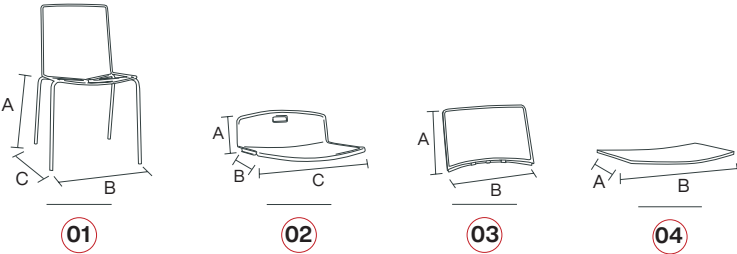

01 duetto-4 legs frames d.16 without caps

A	B	C
450	510	480

02 duetto-plastic seat colored + pf1

A	B	C
180	390	430

03 duetto-plastic back colored

A	B
280	395

04 duetto-seat panel with 6 upholstery nail m6

A	B
395	410

Finishes



CORA

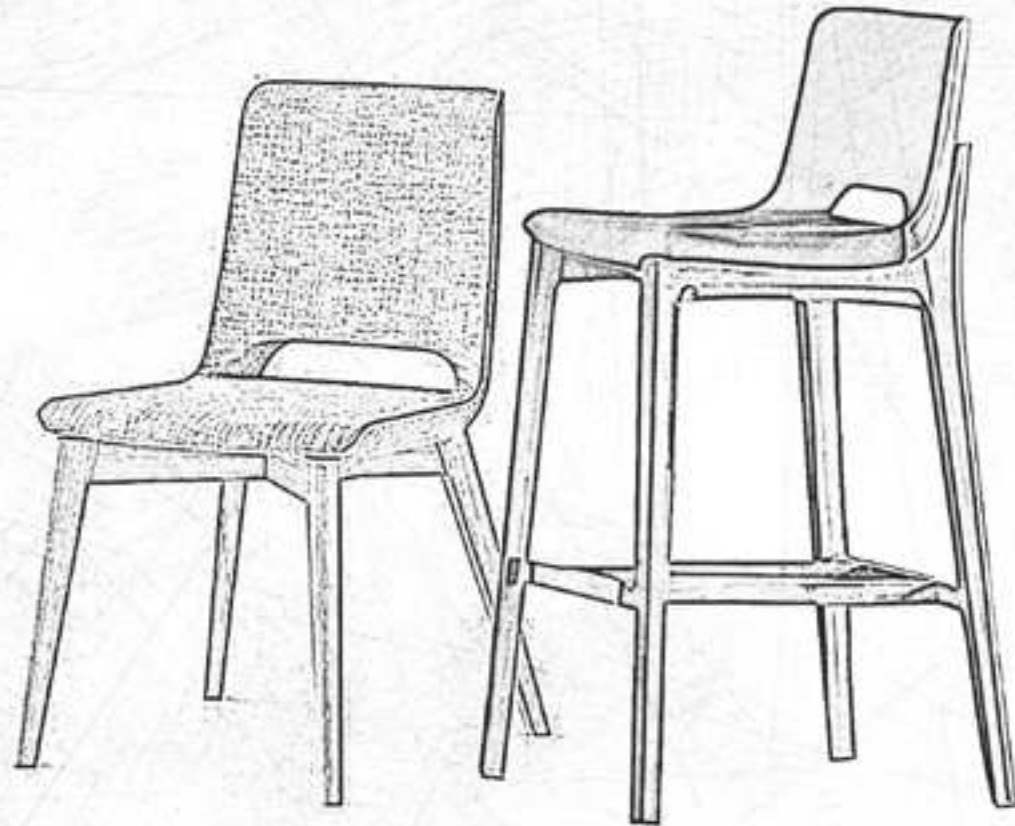

The Cora collection is enriched by a stool version. A subtle balance of elegant, and simple lines that reveal a comfortable seat suited for different settings.



CORA OPEN-L7-H-S

The power of simplicity. With its minimal lines, Cora is a memorable and versatile stool whose comfort adapts to any setting.

- **Weight:** 4.5 kg
- **Overall dimensions:** disassembled 0.05 m³



Steel structure moulded in cold-cure polyurethane foam. Wood slats under the shell to staple the fabric.

- Double hole under the seat for securing various bases.
- Centre to centre distance 140x140 mm and 140x150 mm.



CORA OPEN-L7-S

The lightness of cora is made palpable by the opening in the backrest and the chair's overall clean lines. A streamlined seat that is easy to mix and match and fits into any space with ease.

- **Weight:** 5 kg
- **Overall dimensions:** disassembled shell 0.07 m3



JUNO

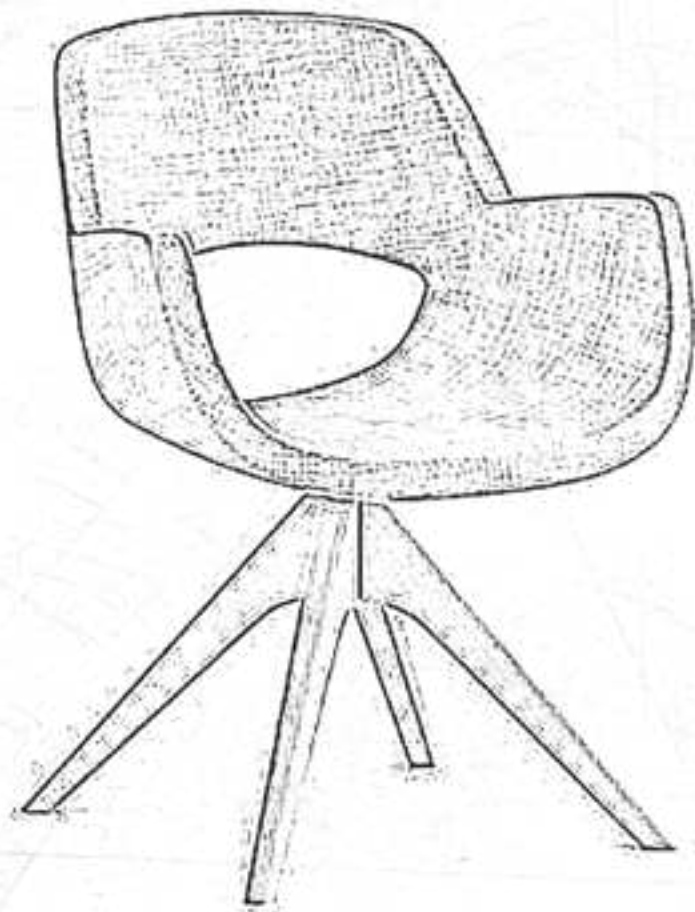

Structure moulded in cold-cure polyurethane foam

- Weight: ca. 6 kg
- Overall dimensions: disassembled ca. 615 mm

JUNO-L7



JUNO-L7



JUNO-R10



JUNO-P10

IRIS

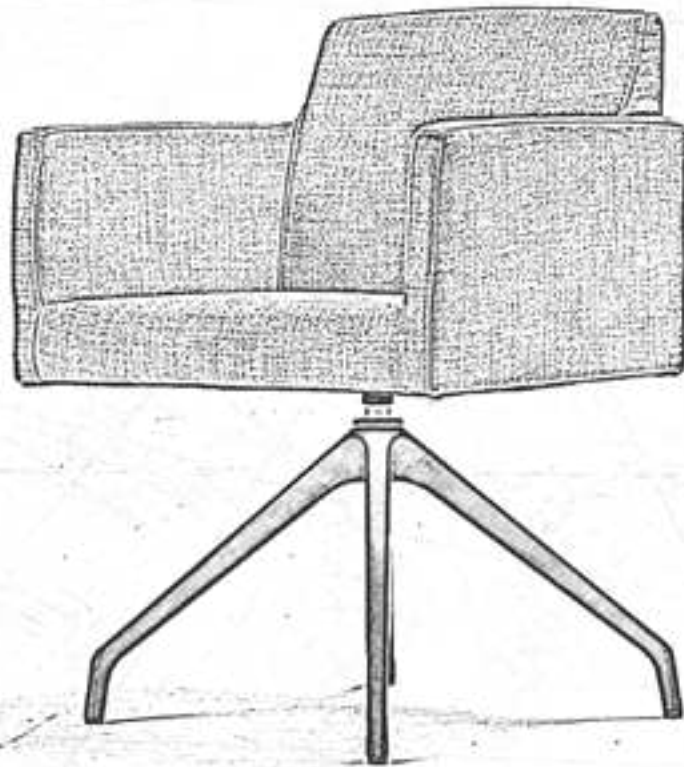

The Iris is a harmonious blend of form and function. Its clean lines and comfortable design make it perfect for both individual and collaborative settings. The chair features a supportive backrest and a contoured seat to ensure all-day comfort. Its adjustable height and tilt mechanism allow for personalized seating, while the built-in lumbar support promotes proper posture. The Iris chair is available in a variety of colors and upholstery options to suit any taste, and its durable construction ensures long-lasting performance. The chair's sturdy five-star base with casters provides smooth mobility and stability, while the gas lift mechanism allows for effortless height adjustment.

Dimensions:

W.45.5 D.52 H.81 Seating H. 50



IRIS-P10

The Iris is available in a variety of colors and finishes to suit any taste. In addition to that, its clean lines and contemporary design add a touch of elegance to any space.



IRIS-R10



IRIS-P10

GLOBAL



The Global family expands with a modern and essential new seat, entirely designed to be adapted to multiple types of stools. A design seat for many different uses, suitable to be assembled on wooden, plastic and metal frames.



18.06.466.99A
H. 750 mm

18.06.465.99A
H. 650 mm

18.06.466.99A
18.06.465.99A

Distinctive photo-engraved detail
on the edge of the seat.

The wooden 4-legs frame version is available in height 650 or 750 mm.
while height 750 mm is ideal for high tables and counters,
the height 650 mm is suitable for more traditional Home environments.

Height : 750 / 650 mm

Finishes



Undershell plate
in black plastic.





Auditorium Chairs

/ SEATING

The Auditorium chairs are designed for comfort, support, and style. The ergonomic design provides optimal support for the user's body, while the plush cushioning ensures a comfortable seating experience.

The chairs are crafted with durable materials and are available in a range of styles and finishes to suit different venue decors.



PY52
CHAIR

PY52

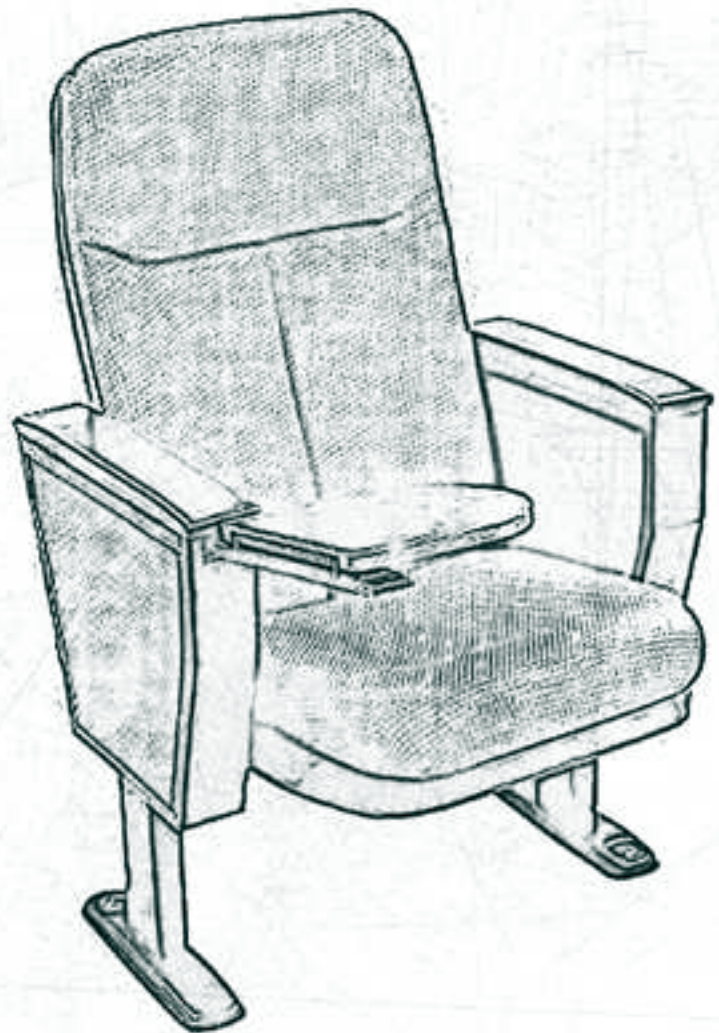

Specifications :

Seat/Back Foam :
High density PU foam.

Seat and back cover :
Injection molded with multiple
composite materials (PP).

Fabric : Polyester.

Armrest Cover : Solid Wood or
molded PU.

Lifting mechanism : By gravity



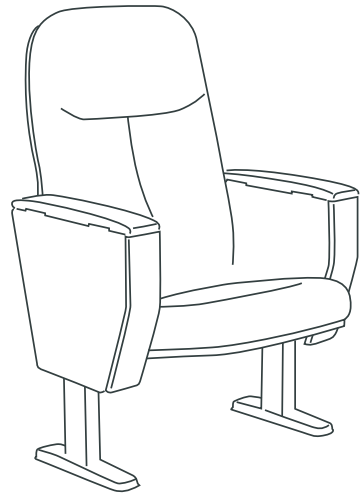

PY52

The Classic Theatre Chair

A timeless, ergonomic design featuring a sturdy base and comfortable seat, perfect for any theatrical performance.

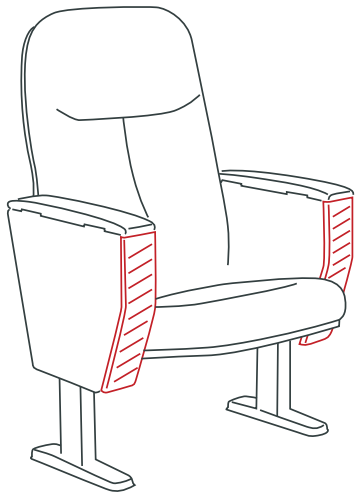

PY52W

The Wood Theatre Chair

A timeless, ergonomic design showcasing a steady wooden frame and armrest. This chair ensures comfort and support.

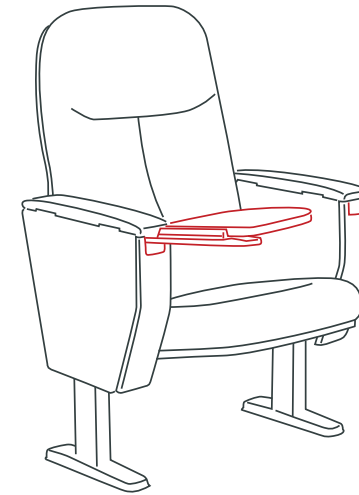

PY52-WP

The Classic Theatre Chair with Writing Pad

Building on the classic design, this chair includes a practical writing pad integrated into the armrest, ideal for note-taking during rehearsals or performances.

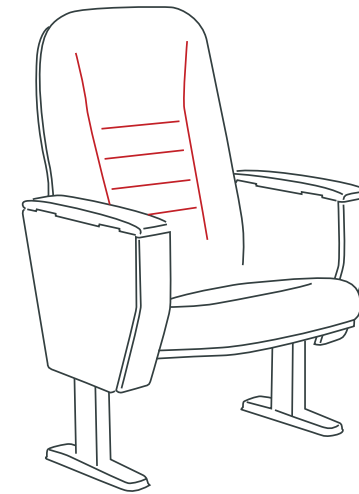

PY52H

The H-Shape Theatre Chair

A new and innovative design featuring a padded H-shaped backrest for added support and comfort, perfect for long performances or rehearsals.

Armrest and leg : Made from top quality steel after precise pressing and welding, and gone through procedures of polishing, anti-rusting, phosphing, spraying and powder coating.



PY52



PY52W



PY52-WOP

PY55

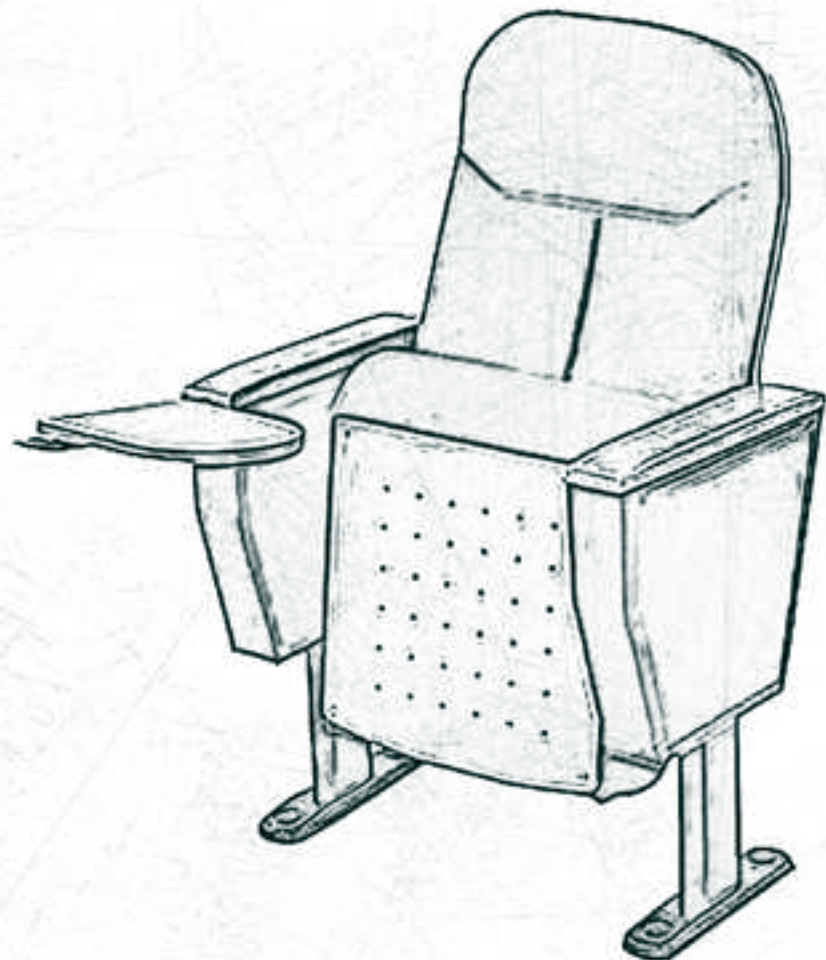

Specifications :

Seat/Back Foam :

High density PU foam.

Seat and back cover :

Injection molded with multiple composite materials (PP).

Seat and back wood :

Molded top quality multi-layer plywood after rotating cutting with painting finished

Fabric : Polyester.

Armrest Cover : Solid Wood or molded PU.

Lifting mechanism : By gravity.



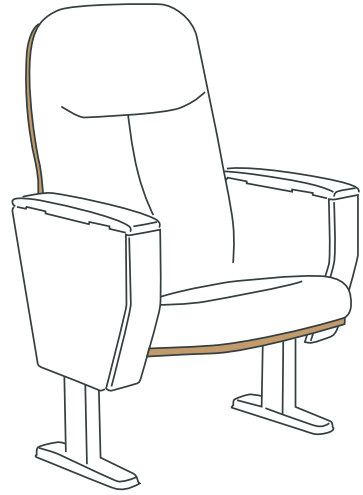

PY55

The Classic Theatre Chair

A timeless, ergonomic design featuring a sturdy base and comfortable seat, perfect for any theatrical performance.

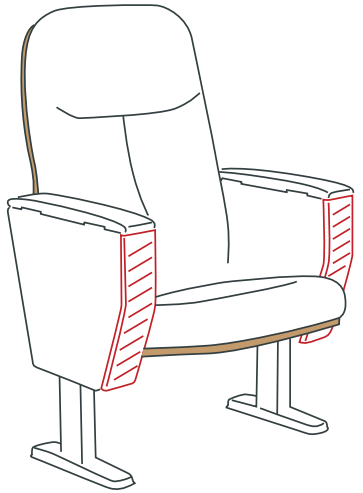

PY55W

The Wood Theatre Chair

A timeless, ergonomic design showcasing a steady wooden frame and armrest. This chair ensures comfort and support.

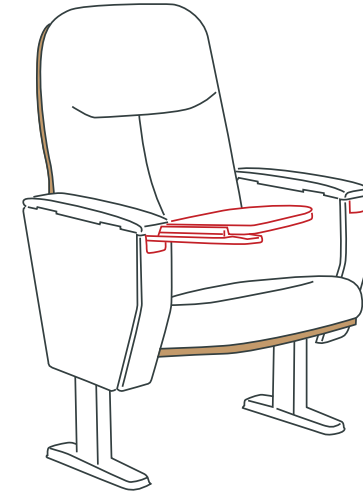

PY55-WP

The Classic Theatre Chair with Writing Pad

Building on the classic design, this chair includes a practical writing pad integrated into the armrest, ideal for note-taking during rehearsals or performances.

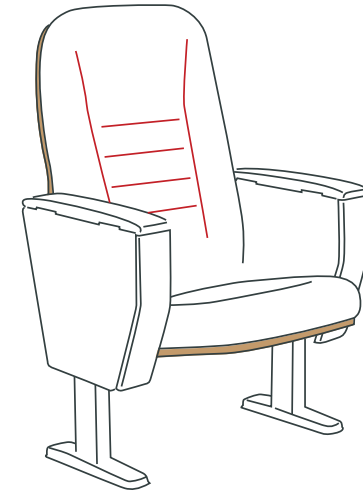

PY55H

The H-Shape Theatre Chair

A new and innovative design featuring a padded H-shaped backrest for added support and comfort, perfect for long performances or rehearsals.

Armrest and leg : Made from top quality steel after precise pressing and welding, and gone through procedures of polishing, anti-rusting, phosphing, spraying and powder coating.

Wood Veneer Finishes



RV01
PALISANDER

RV02
BEECH



RV03
WALNUT

RV04
CHERRY



PY55



PY55



PY55H

PY24

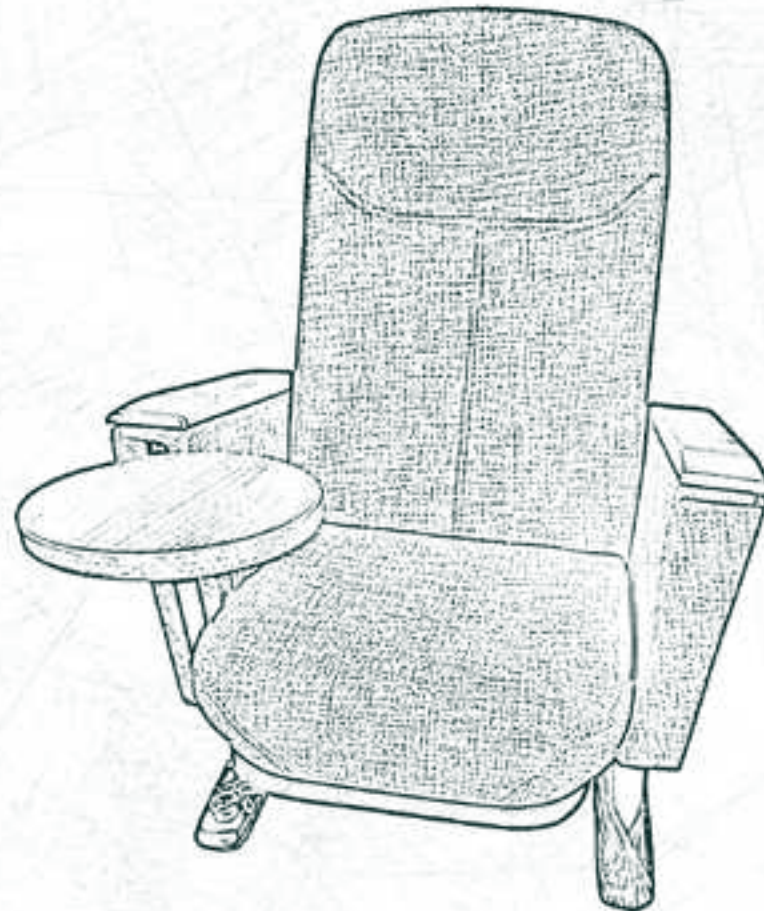

Specifications :

Seat/Back Foam :

High density PU foam.

Seat and back cover :

Injection molded with multiple composite materials (PP).

Seat and back wood :

Molded top quality multi-layer plywood after rotating cutting with painting finished

Fabric : Polyester.

Armrest Cover : Solid Wood or molded PU.

Lifting mechanism : By gravity.





Auditorium Chairs Dimensions

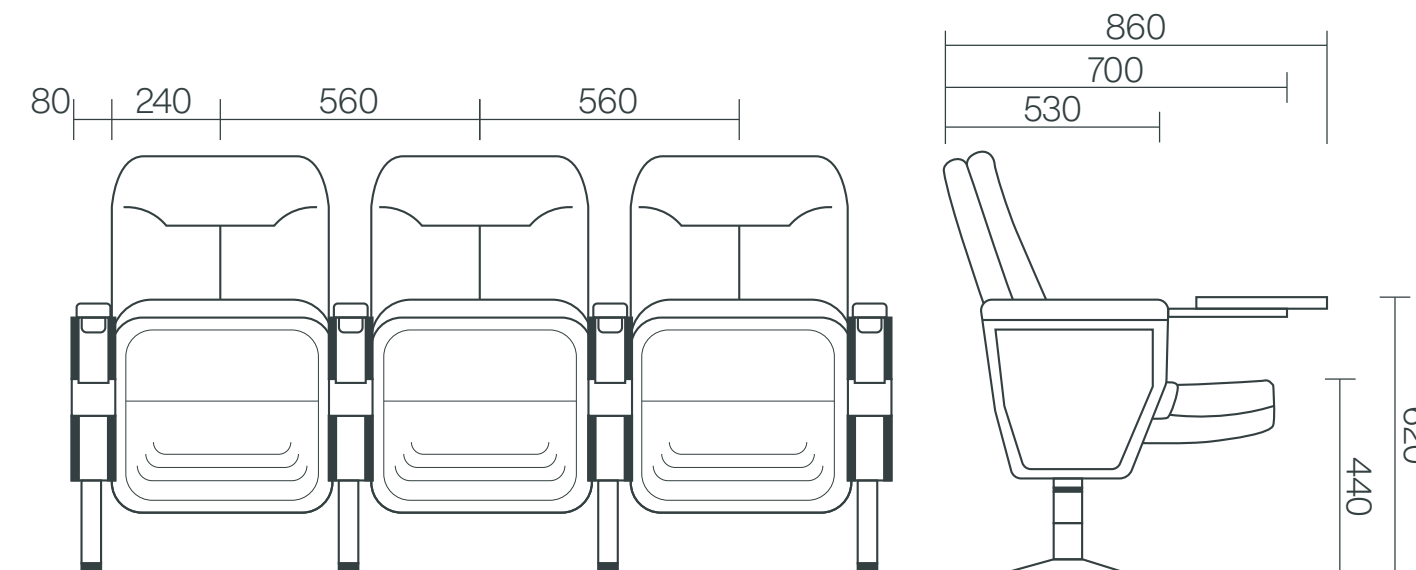



Seating Finishes



SEATING FINISHES

Fabrics & Leather

Category A

FABRICS
ASCOT



RF001
TAUPE 09 (L.GREY)

RF002
ATLANTIC 16 (BLUE)

RF003
GRAPHITE 11 (D.GREY)

FABRICS
OXFORD



RF004
RED

FABRICS
BRISTOL



RF005
ANTHRACITY (BLACK*WHITE)

RF006
MARSALA (RED*WHITE)

FABRICS
BROOKLYN



RF007
TRUFFLE (BEIGE)

RF008
CEMENT (L.GREY)

RF009
ANRKET (D.GREY)

RF010
BOKYL (L.GREEN)

LEATHER
SANTANA



RL001
005 (L.BEIGE)

RL002
310 (HAVAN ORANGE)

RL003
340 (D.GREEN)

SEATING FINISHES

Fabrics

Category B

FABRICS
KOYA



RF011
1 (L.BIEGE)

RF012
5 (BIEGE)

RF013
10 (L.GREY)

RF014
15 (D.BIEGE)

RF015
12 (D.GREY)

RF016
20 (BROWN)

RF017
22 (DUSTY YELLOW)



RF018
23 (LEMON GREEN)

RF019
51 (BLUE)

FABRICS
BALTIMORE



RF033
TOFFEE

RF034
KAKY

RF035
ELEPHANT

SEATING FINISHES

Fabrics
Category B

FABRICS
MUSA



RF020
MIX BROWN



RF021
BLACK



RF022
WHITE



RF023
MUSTARD YELLOW



RF024
ORANGE



RF025
RED



RF026
BLUE



RF027
NEW GREY (L.GREY)



RF028
D.GREY



RF029
SAND (D.BEIGE)



RF030
YELLOW



RF031
GREEN



RF032
NATA (OFF WHITE)

FABRICS
KENYA



RF036
ASH 13 (L.GREY)



RF037
ASH 14 (D. GREY)

SEATING FINISHES

Leather
Category B

LEATHER
TK



RL004
603 (L.GREY)



RL005
277 (RED)



RL006
006 (BEIGE)



RL007
345 (D. BROWN)



RL008
601 (D. GREY)



RL009
901 (BLACK)

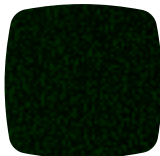

RL010
425 (D.GREEN)

LEATHER
SG



RL015
360 (LBROWN)



RL016
370 (BROWN)



RL017
380 (TOFFEE)



RL018
005 (BEIGE)



RL019
606 (D.GREY)

LEATHER
GLS



RL011
1068 (BLUE)



RL012
1032 (H-AVANI)



RL013
17 (D.GREY)



RL014
917 (RED)

SEATING FINISHES

Fabrics
Category C

FABRICS
SABIA

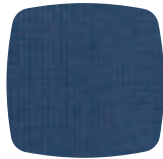

RF041
219 (NAVE)



RF042
1780 (YELLOW)

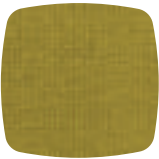

RF043
1945 (GREEN)



RF044
1859 (MANDRINE)



RF045
1815 (RED)



RF046
1002 (METAL-L.GREY)



RF047
1989 (STEEL-D.GREY)



Care Instructions

FABRICS

The colors are only indicative. The color tones may vary between dyebaths. This is not a fault and is not covered by any guarantee. It's not recommended to place any products in direct sunlight or spotlights as it may cause color changes. Heavy and sharp objects cause permanent damages on products.

Fabric. The fabrics are composed of more than one material and show a great variety. They have different cleaning label depending on the fabric composition.

Organic fabrics should be treated with solvent based cleaners. Run hand towel or stiff brush over the surface to loosen dried-on stains. Sprinkle with baking soda and let sit for 20 minutes. Vacuum using an upholstery attachment. Use the cleaner and white cloth to treat stains. Synthetic fabrics can be cleaned with water based cleaners. The surface should be vacuumed with an upholstery attachment and sprayed with the cleaner. Gently scrub the fabric in circular motion with a clean and white cloth until dry. To successfully clean fabric, it is important to determine the type of fabric and the recommended cleaning code that can be found on the law tag attached to the furniture. Generally, to clean the surface, use a soft cloth and a mild soap solution. Avoid using harsh chemicals or abrasive cleaners, as they can damage the fabric or stain it. It's also important to dry the fabric thoroughly with a soft cloth to prevent water spots. Regular cleaning and maintenance will help to preserve the appearance and comfort of the fabric.

LEATHER

Genuine leathers may have scratches, bites or other types of marks with irregularities which are completely normal and expected. This indicates the natural habitats of the animals. It should be considered as marks of quality and authenticity.

Genuine leather is not an elastic material and it pulls on the products. This effect is more recognizable on soft surfaced products. Some leathers are very easily marked and some can be brushed in different directions.

Do not use bristles to clean the leather, remove the dust with a soft and dry cloth. Do not place in direct sunlight or spotlights as it may cause color changes. Apply leather creams every six months to keep the leather elasticity and prevent dehydration. Applying a neutral soap on the stains may give good results. Strong cleaners, detergents xylene-based solutions or acetone can cause immediate damage and deteriorate the material. Using these materials are customer's own risk.



ISO 9001 is an internationally recognized standard that specifies requirements for a quality management system (QMS)



FIRA ensures that manufacturers and suppliers meet high standards of quality and performance in products.



BIFMA assuring to adhere to industry standards, promoting safety, durability, and sustainability in furniture products.



INTERTEK ensure products meet regulatory requirements, quality standards, and environmental impact assessments.



GREENGUARD verifies that products have low chemical emissions, and reducing exposure to potentially harmful pollutants.

SUSTAINABILITY



Riadco prioritizes sustainability in all aspects of its operations through constant communication with local institutions, use of local suppliers, materials, and focusing on research with investment in eco-friendly processes. It is rooted in Riadco's core values to support people, communities, and the planet while crafting furniture that promotes optimal performance and minimizes environmental impact.





Riadco is certified

ISO 14001

ISO 9001

ISO 45001

2, 3 block 13021
1st industrial zone,
Obour city, Cairo, Egypt.

+20 2 4481 0534
www.riadco.com
info@riadco.com



Riadco is certified

ISO 14001

ISO 9001

ISO 45001

2, 3 block 13021 1st industrial zone,

Obour city, Cairo, Egypt

+20 2 4481 0534

www.riadco.com

info@riadco.com

Rev.1_2025

Copyright 2025 Riadco. Cairo - Egypt. All rights reserved. Confidential material of relevant economic value, property of Riadco. Reproduction and/or disclosure, even partial, to third parties is prohibited without specific written authorisation from Riadco management. Riadco reserves the rights at all time to apply modifications for the functional or qualitative improvement of its products. Texts and drawings present in this catalogue have a divulgative purpose.